

BATTERY REPLACEMENT REAL® 6100 PLUS

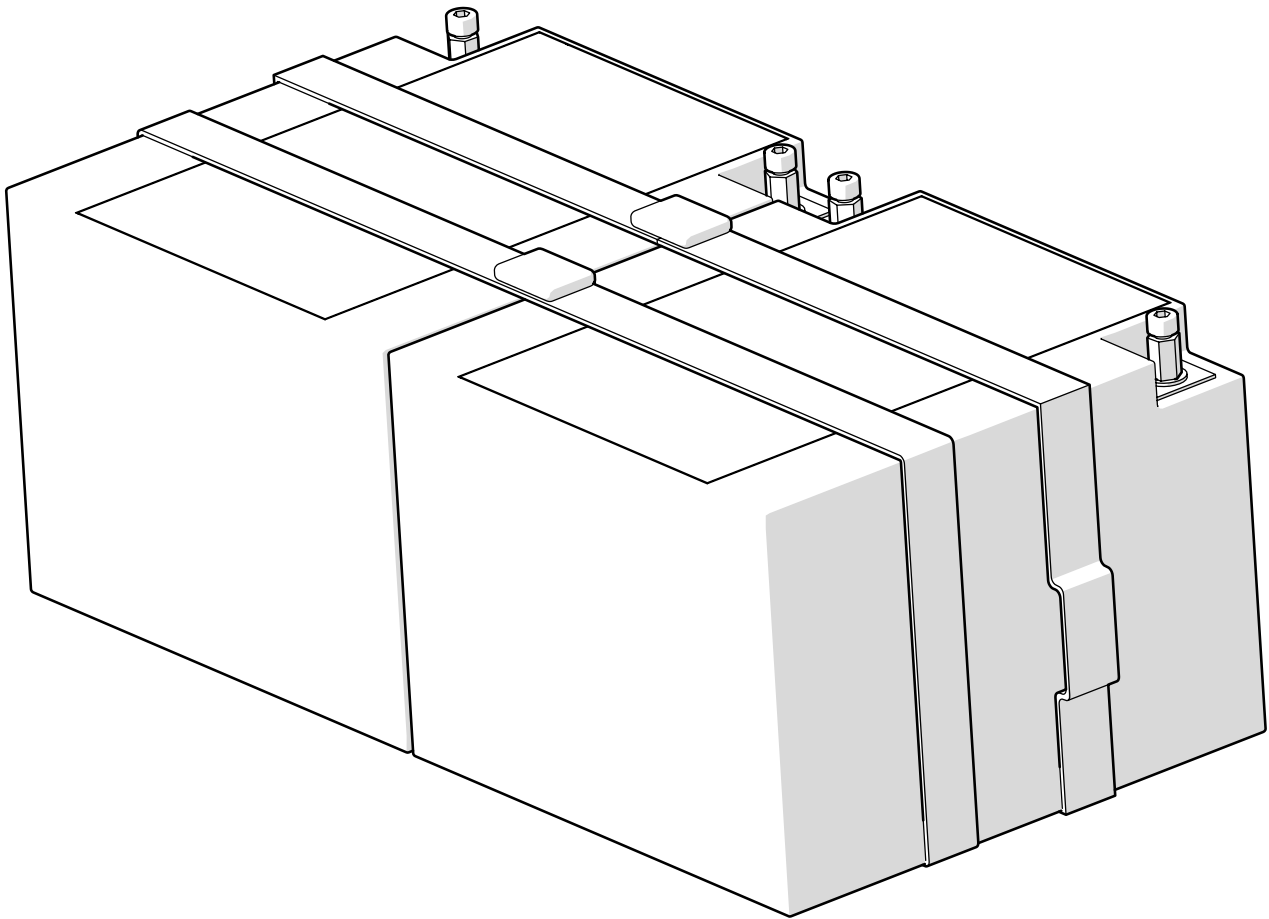

Battery replacement REAL® 6100 PLUS

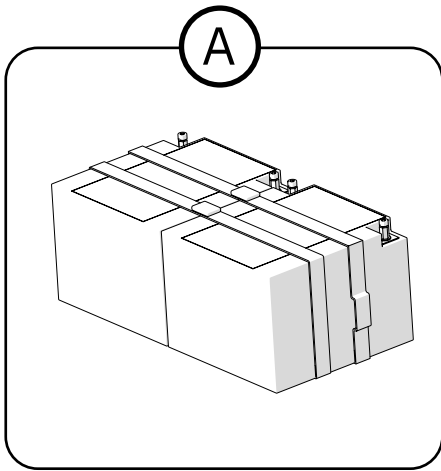

- Ⓐ BA1010 Battery Pack 24V/25Ah Sonnenschein for REAL 6100 PLUS
- BA1020 Battery Pack 24V/28Ah FGS for REAL 6100 PLUS



Before commencing replacement of batteries, make sure that you have switched off the circuit breaker.

Bear the following in mind when handling batteries:

- Never short-circuit the battery.
- Do not subject the battery to strong shocks.
- Always dispose of used batteries at recycling centres.
- Be careful when lifting the battery pack as this is heavy and may cause injury/damage to both person and property if dropped.
- Always reinstall the battery terminal protective cover. The absence of the protective cover may result in personal injury during subsequent service.

First aid

If the battery is defective and handling it results in direct contact with the contents of the battery, electrolytes (sulphuric acid), the following applies:

Incident	Action
Skin contact	Rinse with water. Clean with soap and water. Remove and wash affected clothes.
Inhalation of acid mist	Breathe fresh air. Seek medical attention immediately!
Contact with eyes	Wash eyes with running water for at least 15 minutes. Seek medical attention immediately!
When swallowed	Immediately drink plenty of water, do not induce vomiting. Seek medical attention immediately!

Battery replacement REAL® 6100 PLUS

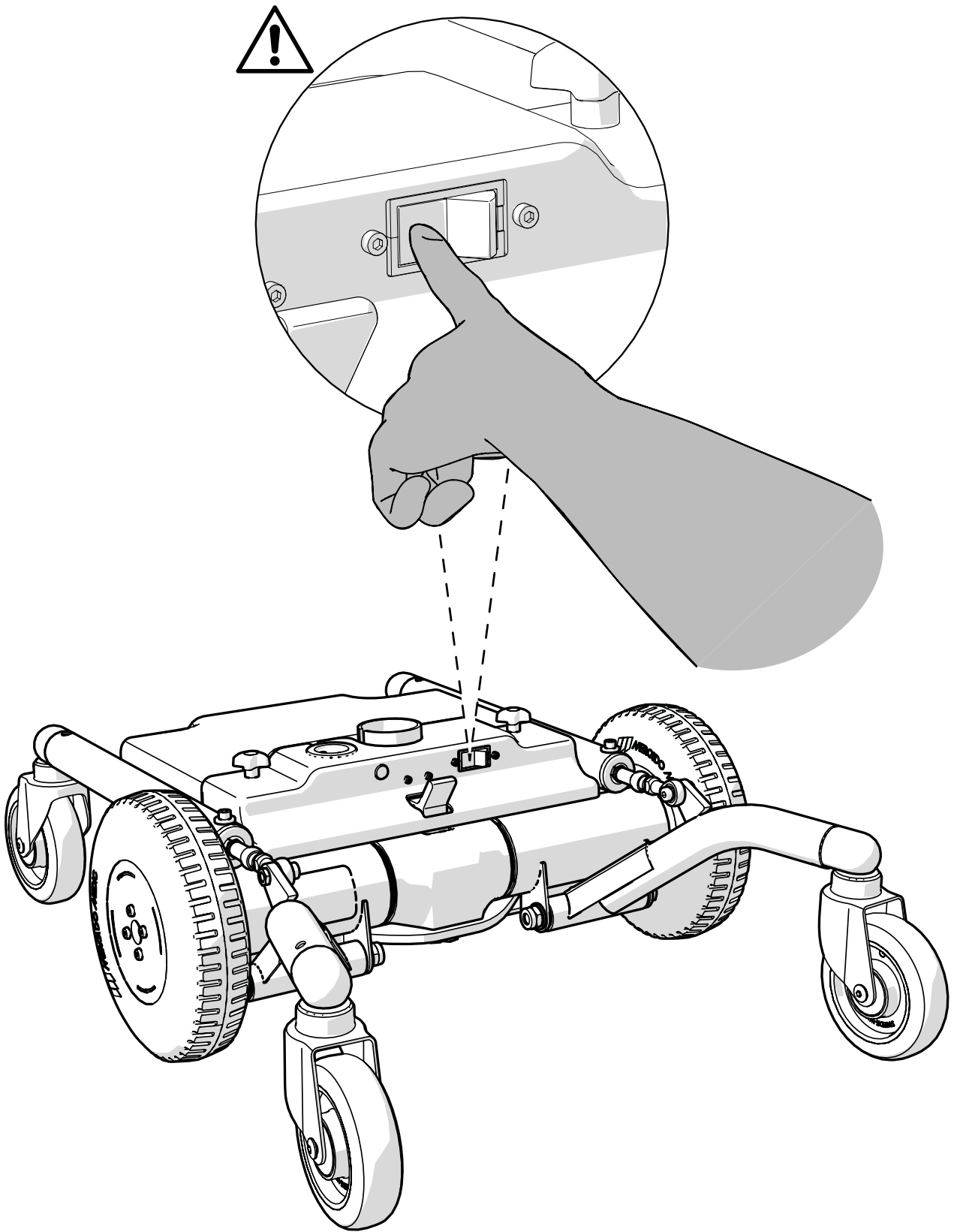

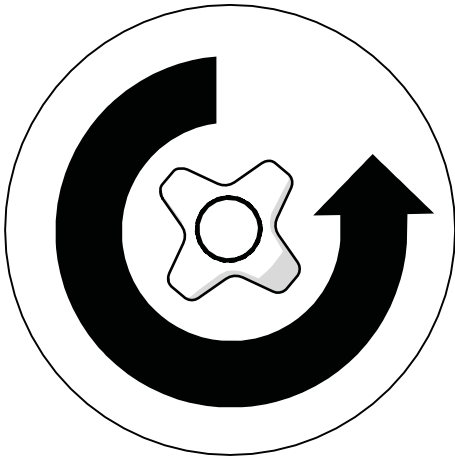

x2

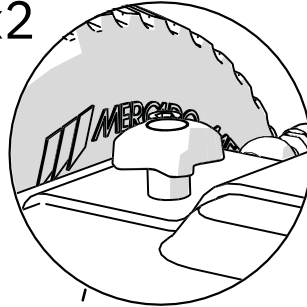

x2

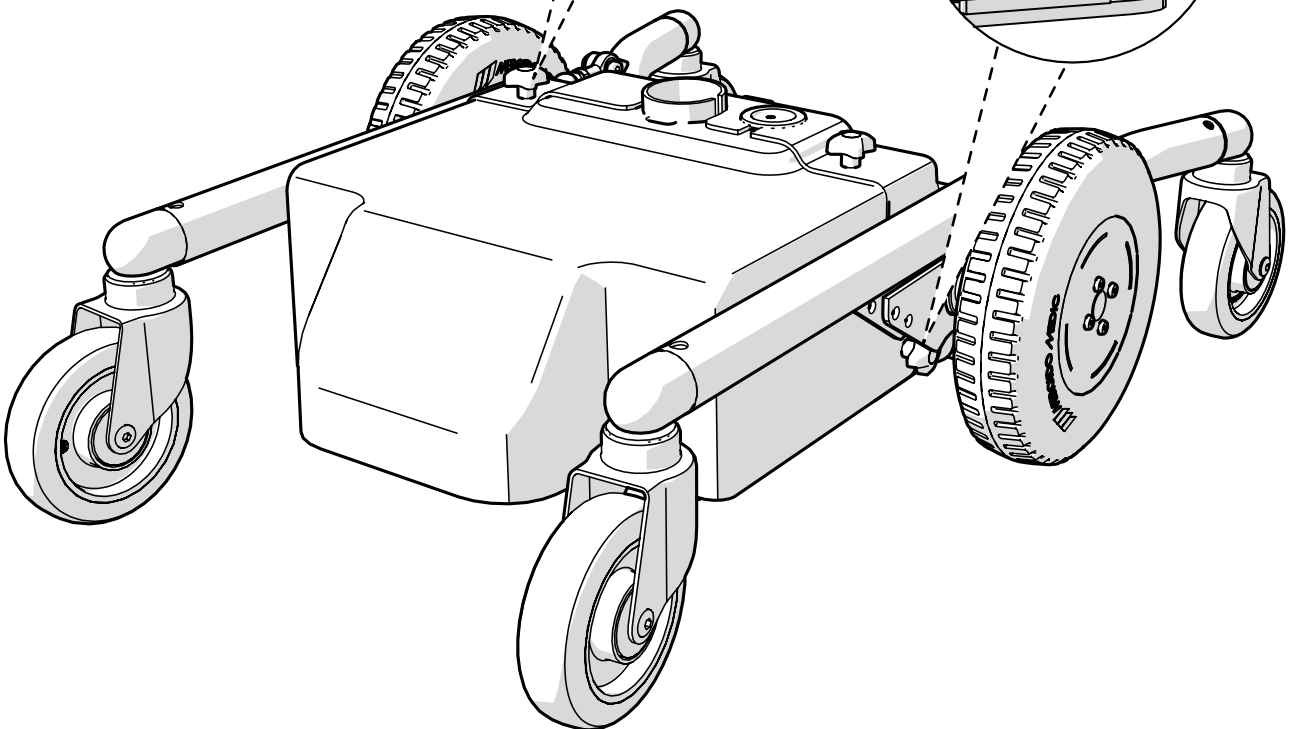
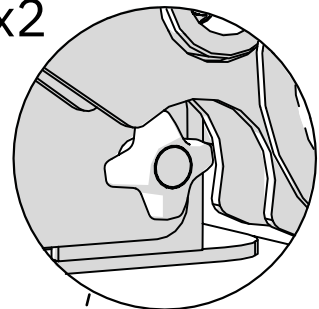

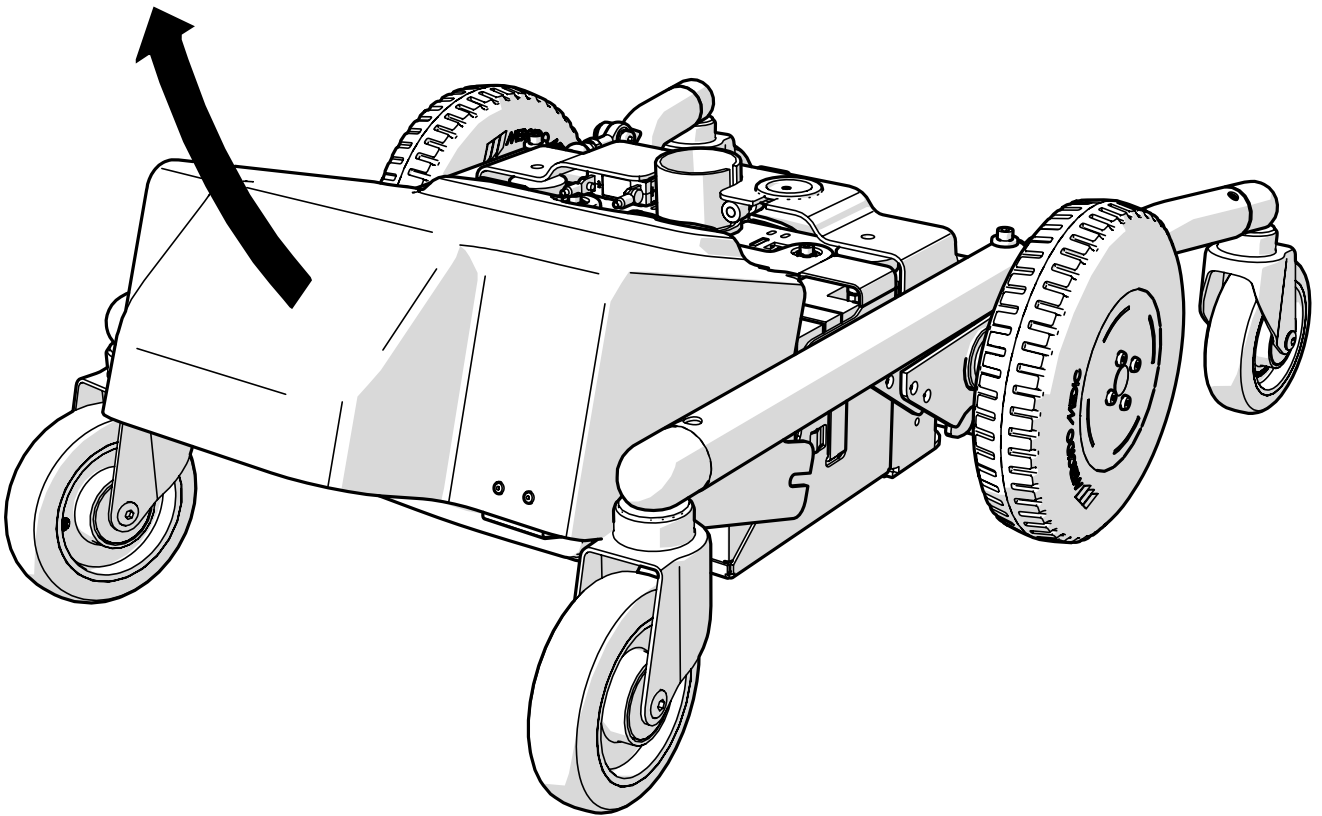

Battery replacement REAL® 6100 PLUS

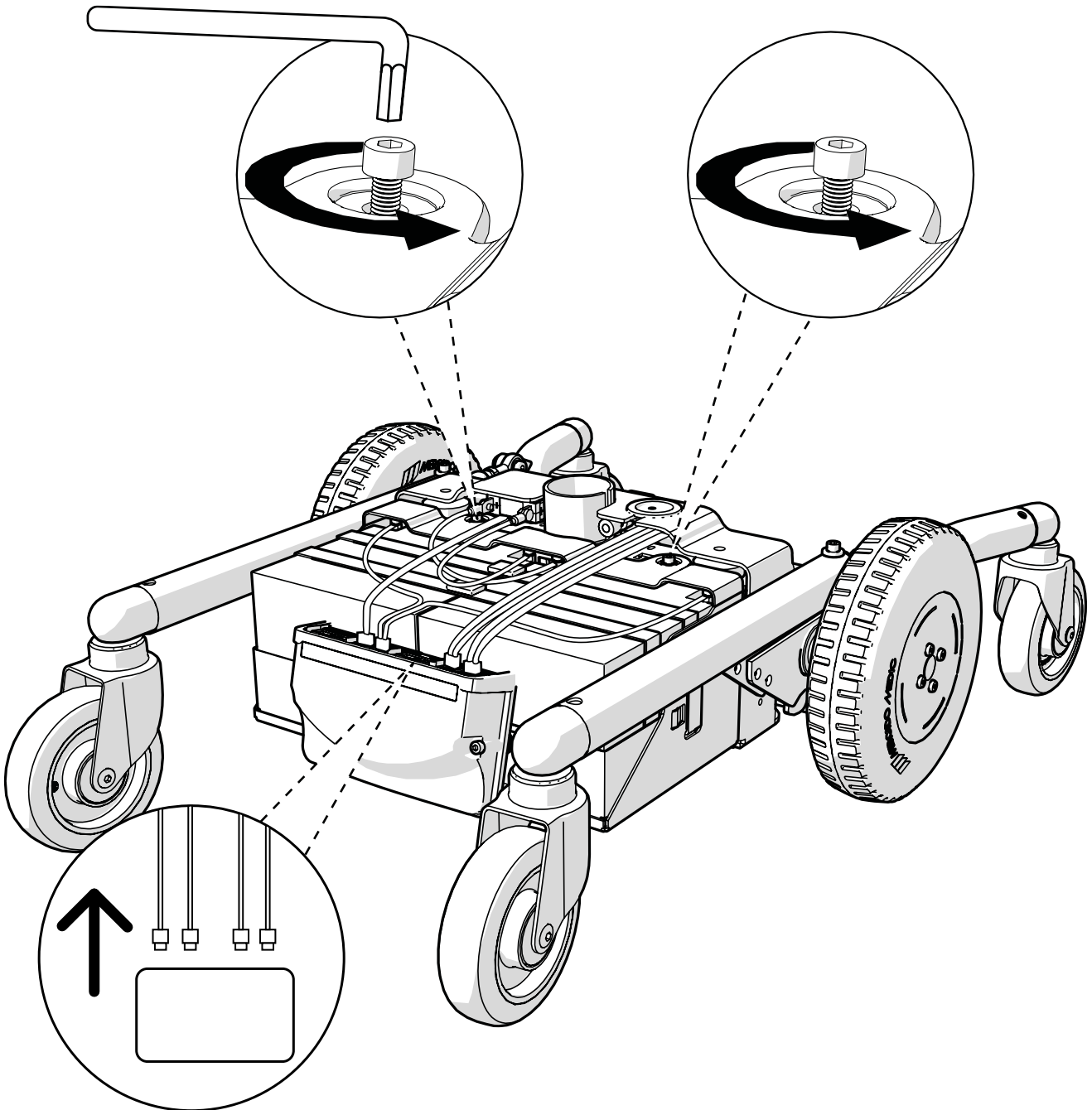

Battery replacement REAL® 6100 PLUS

i

If the chair does not have a battery protective cover, do not install the accompanying battery terminal spacers on the new batteries.

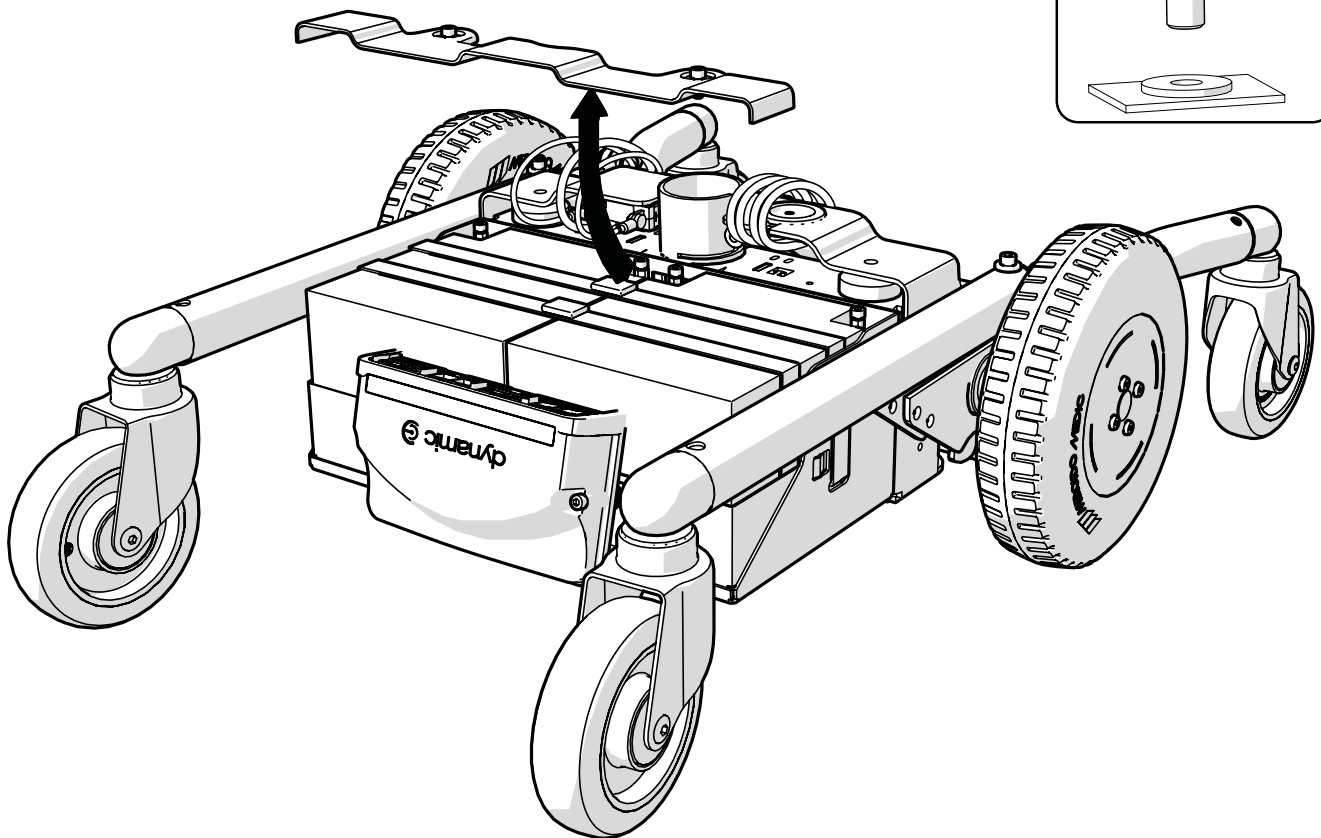
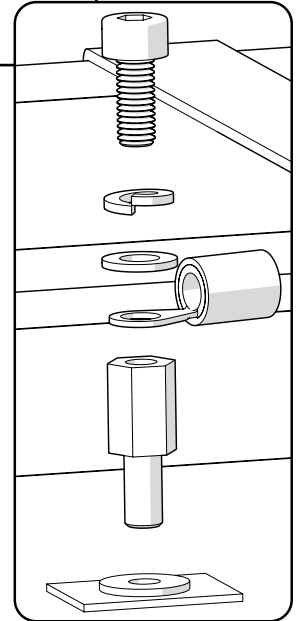

Battery replacement REAL® 6100 PLUS

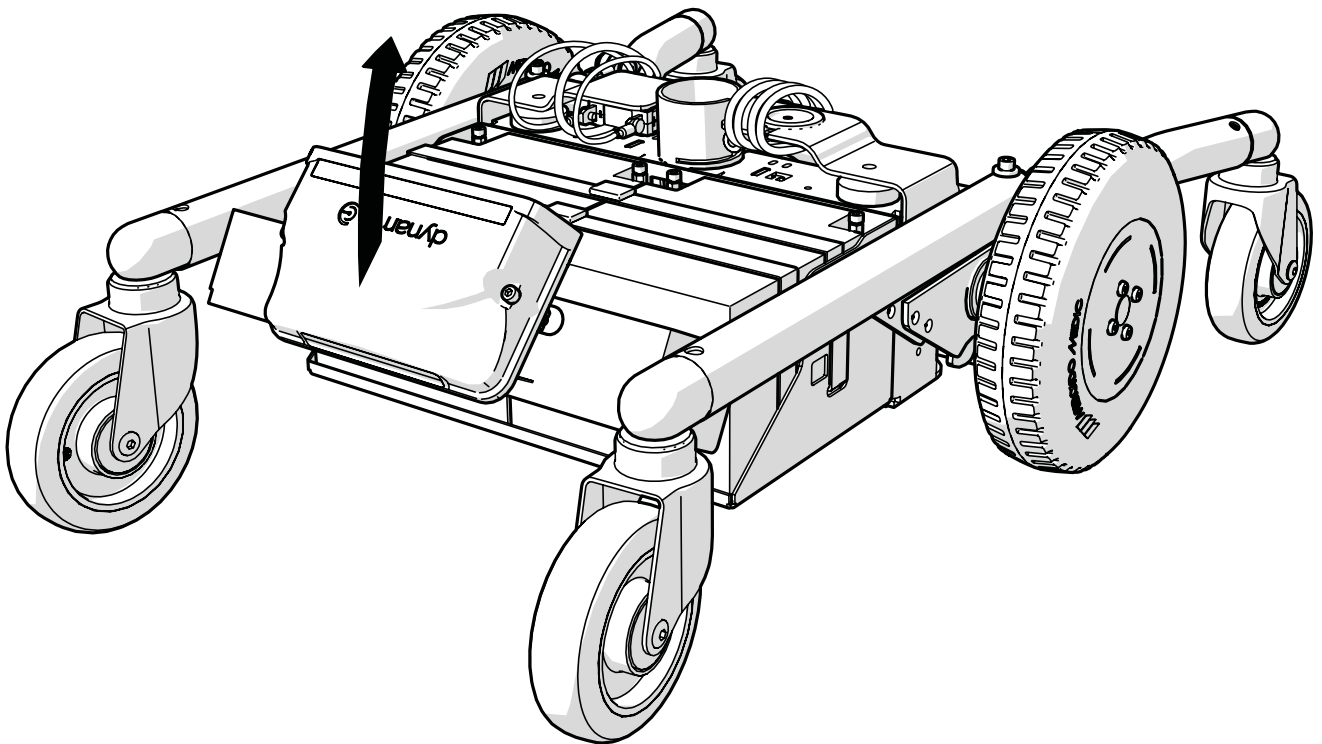

Battery replacement REAL® 6100 PLUS

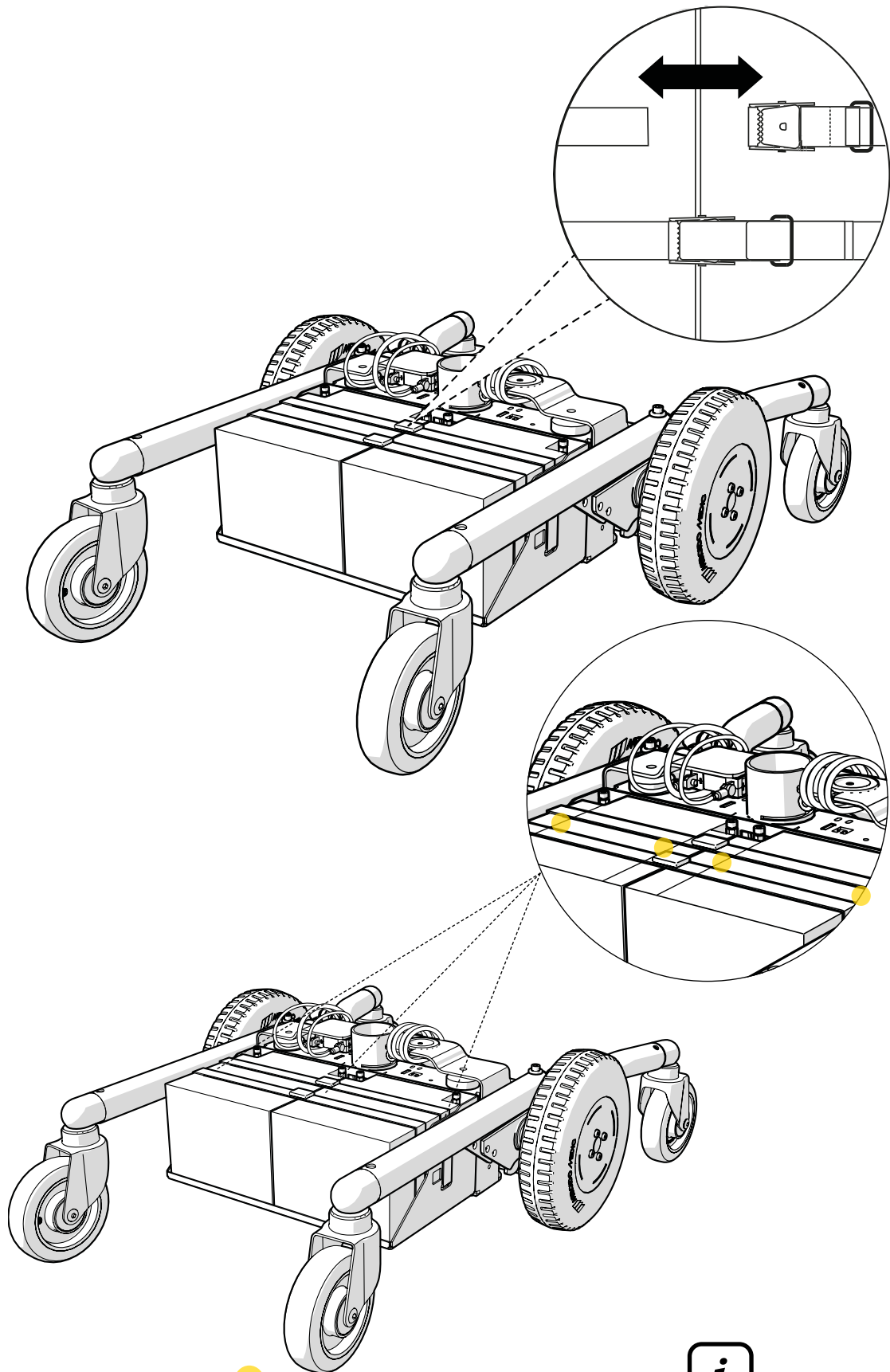

i

To ensure proper functionality and prevent battery damage, it is crucial that the ventilation holes are always kept open and free from obstructions. The ventilation holes are small openings designed to release gas that may form during the charging process. The ventilation holes can be found in the middle of the groove running along the top side of the battery, as indicated by the yellow markings. If the ventilation holes are covered, the gas cannot escape properly, which shortens the lifespan of the batteries.

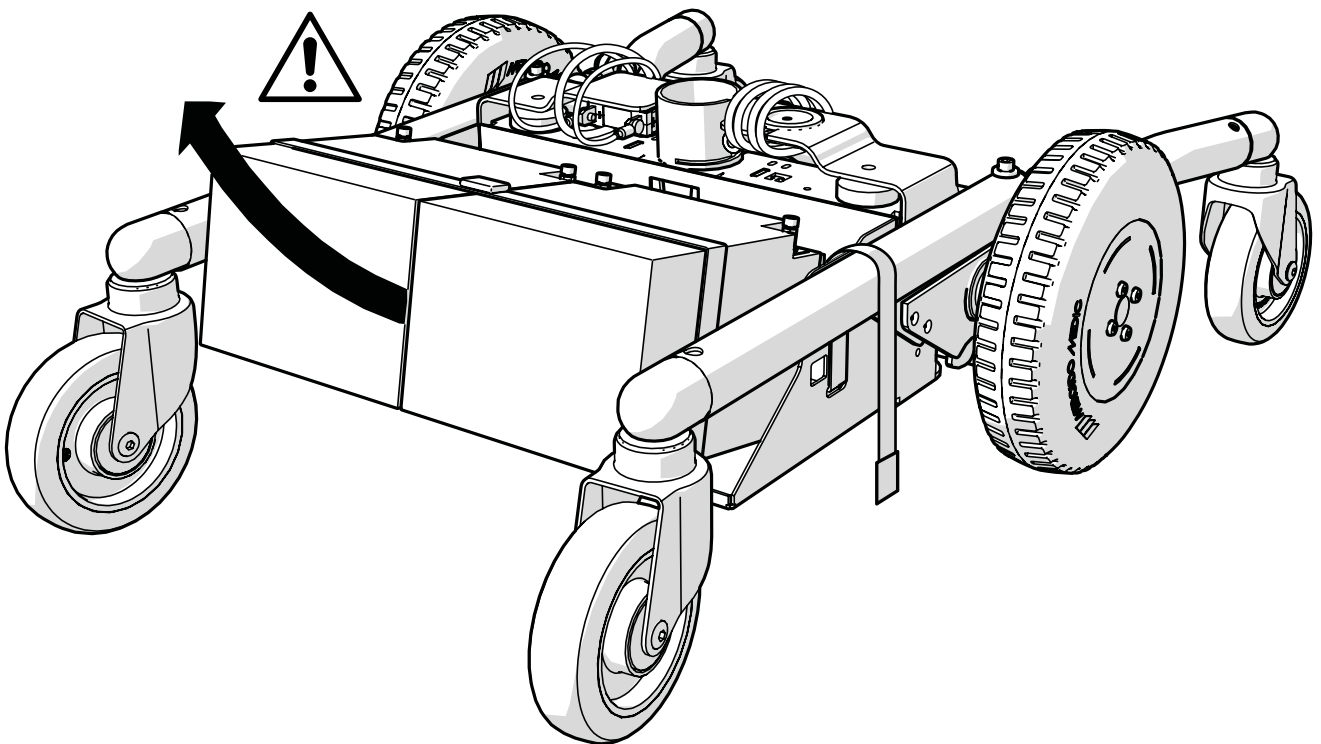

i

Perform the previous steps in reverse order to complete the battery replacement, Be sure to connect the power module in accordance with the wiring diagram found on the inside of the battery cover.

! Make sure that all electrical functions work before the product is returned to service.

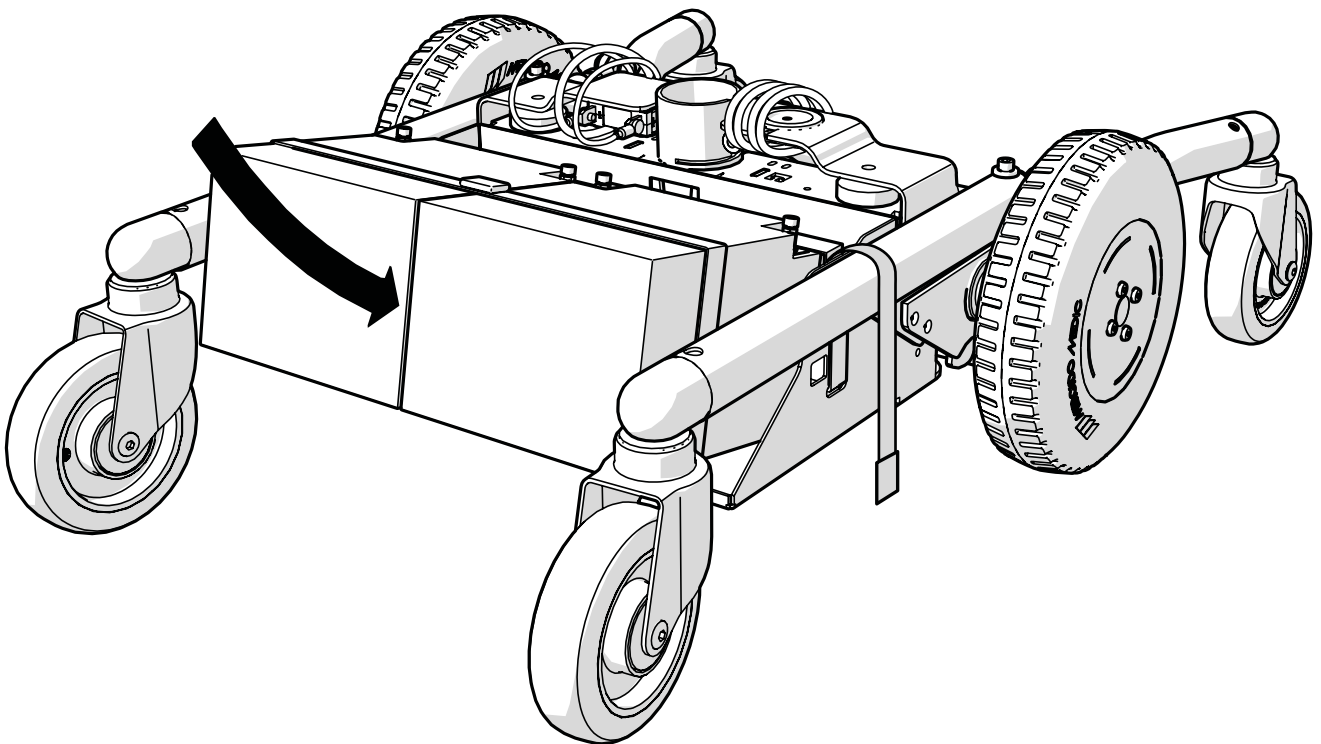

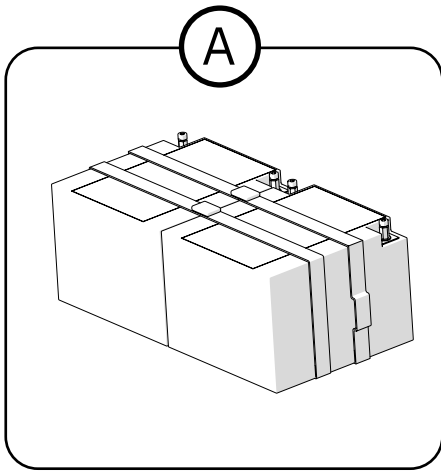

Maintenance instructions

The product should be wiped down and kept clean from dust and dirt. We approve the use of detergents with a pH level ranging from 7 to a maximum of 12 (concentrated).

Destruction

Ⓐ Sort as for lead batteries