



ELECTRIC LENGTH COMPENSATING LEG SUPPORT FOR REAL 6100 PLUS

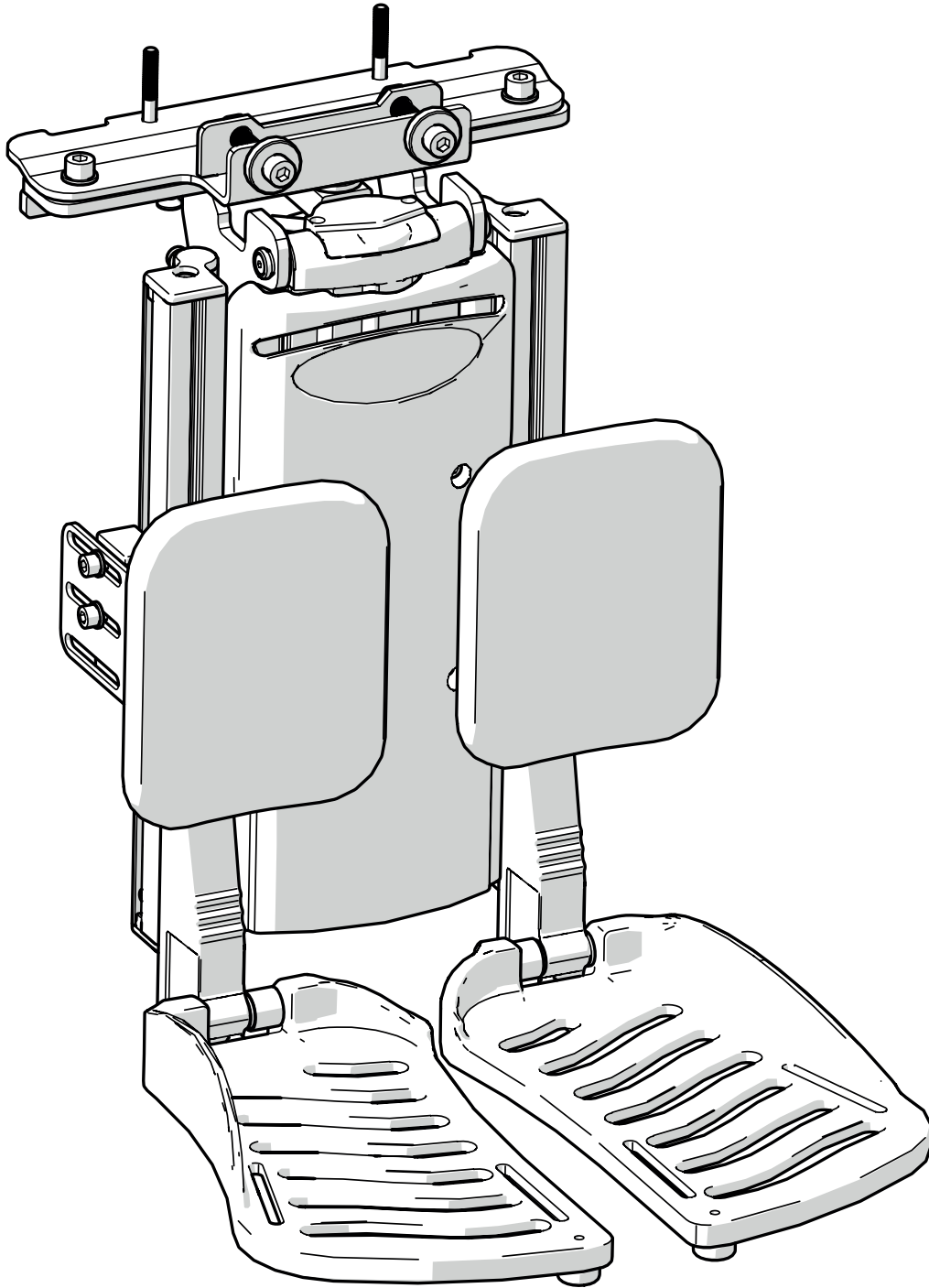
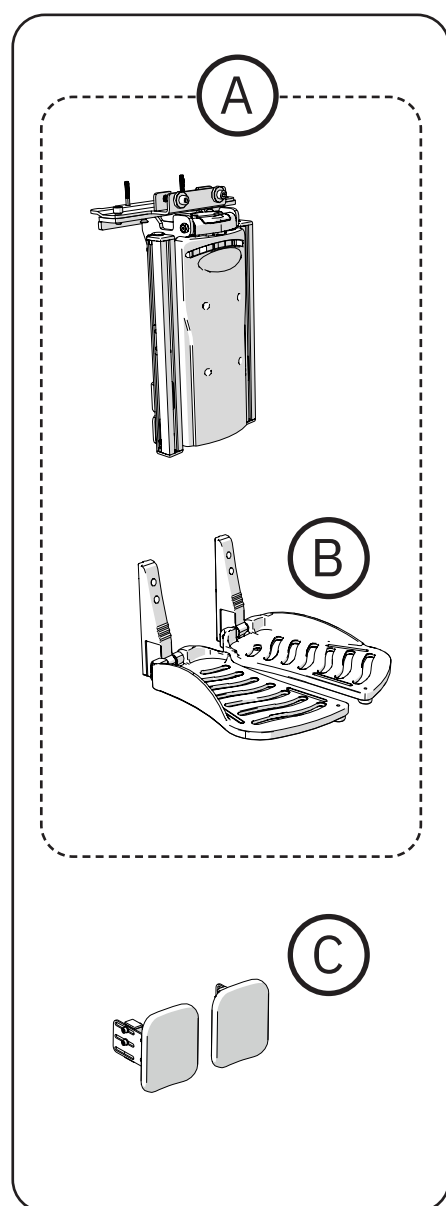

Table of content

- 1. Item list 3
- 2. Warnings 4
- 3. Assembly instructions 5
 - 3.1. Install the footplates 5
 - 3.2. Install the calf supports..... 6
 - 3.3. Install the adapter plate 7
 - 3.4. Install the adapter plate 8
 - 3.5. Install the leg support 9
 - 3.6. Install the leg support
seat depth 48 and larger 10
 - 3.7. Connect the electronics 11
- 4. Care instructions 12
- 5. Disposal and recycling 12

1. Item list



- A** LS311110 Leg Support Electrical R+L Length Comp Long footpl 30 cm excluding Calf Support
 LS311111 Leg Support Electrical R+L Length Comp Short footpl 25 cm excluding Calf Support
 LS311112 Leg Support Electrical Length Comp. including footplates 30 cm excluding Calf Support f seat depth >48
 LS311113 Leg Support Electrical Length Comp. including footplates 25 cm excluding Calf Support f seat depth >48
- B** 805093 Footplate Short 25cm for Electric Length Comp Leg support REAL 6100 PLUS
 805094 Footplate Long 30cm for Electric Length Comp Leg support REAL 6100 PLUS
- C** CS501458 Calf Support cpl R+L for Length comp Leg Support LS3111* Neoprene Black

2. Warnings

**Warning!**

There is a risk of crushing when operating the chair's functions. Pay attention to the following risks:

1. Risk of crushing between leg support and seat frame
2. Risk of crushing between leg support and chassis
3. Risk of crushing between leg support and floor

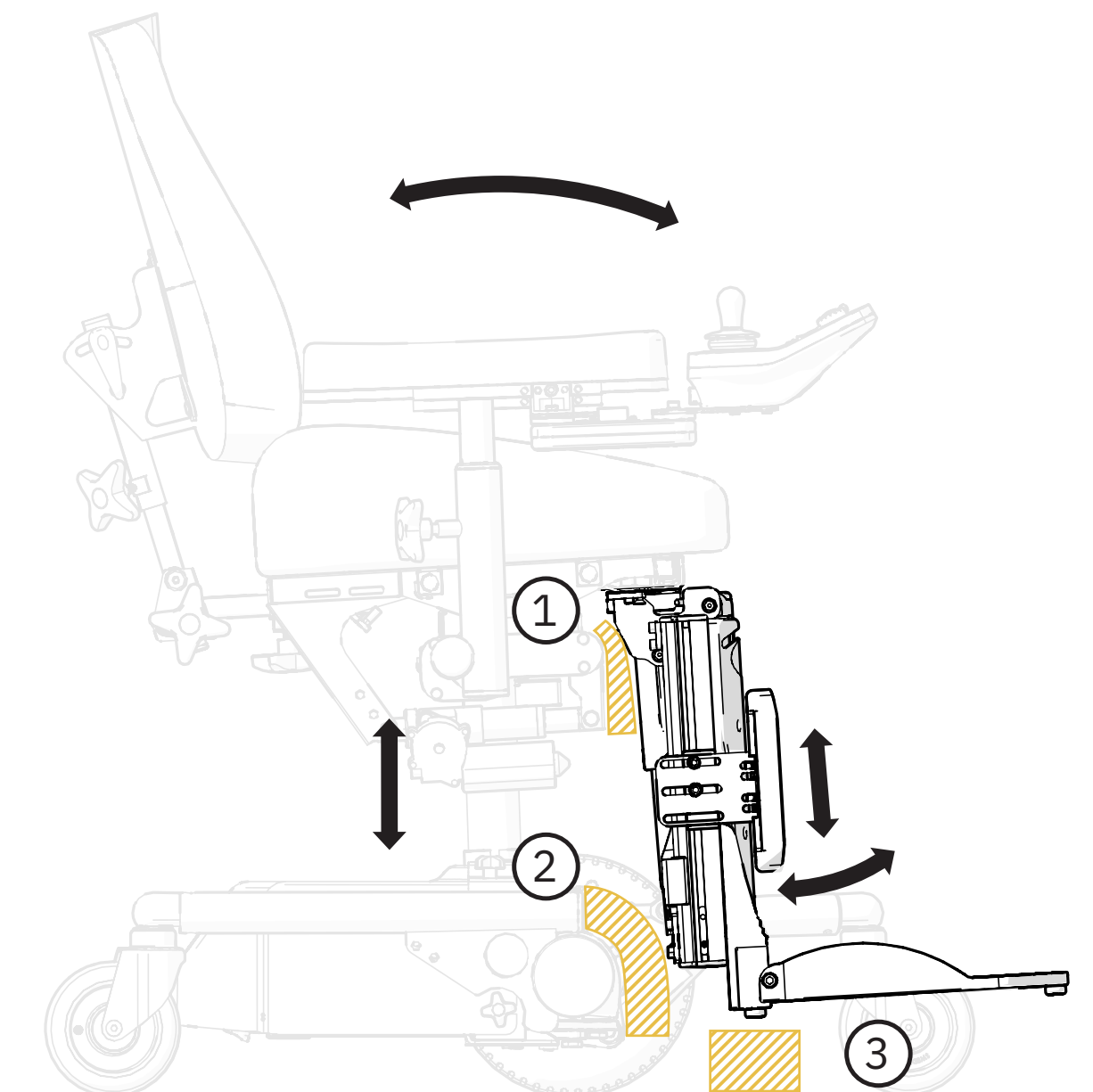

3. Assembly instructions

3.1. Install the footplates

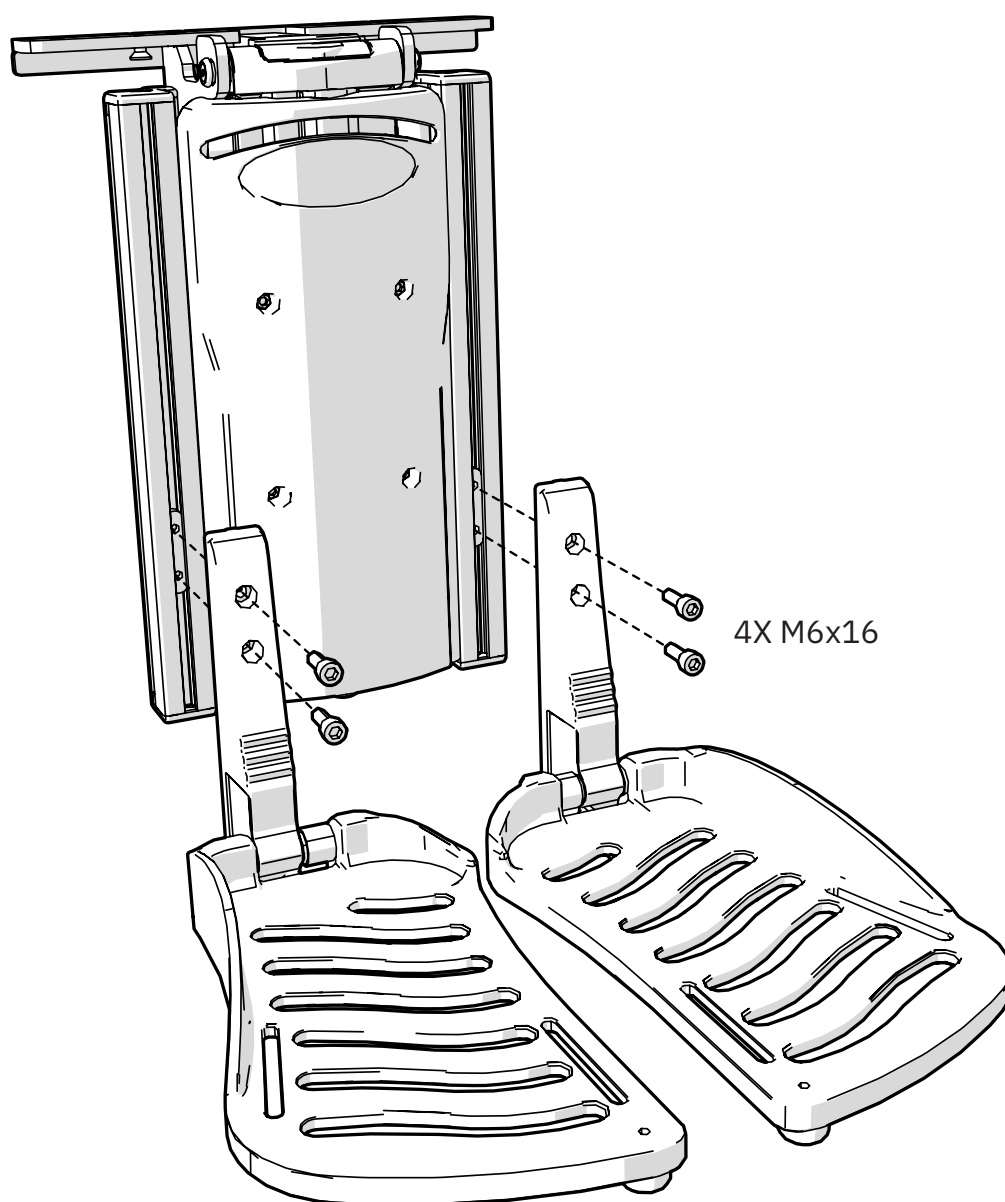

3.2. Install the calf supports

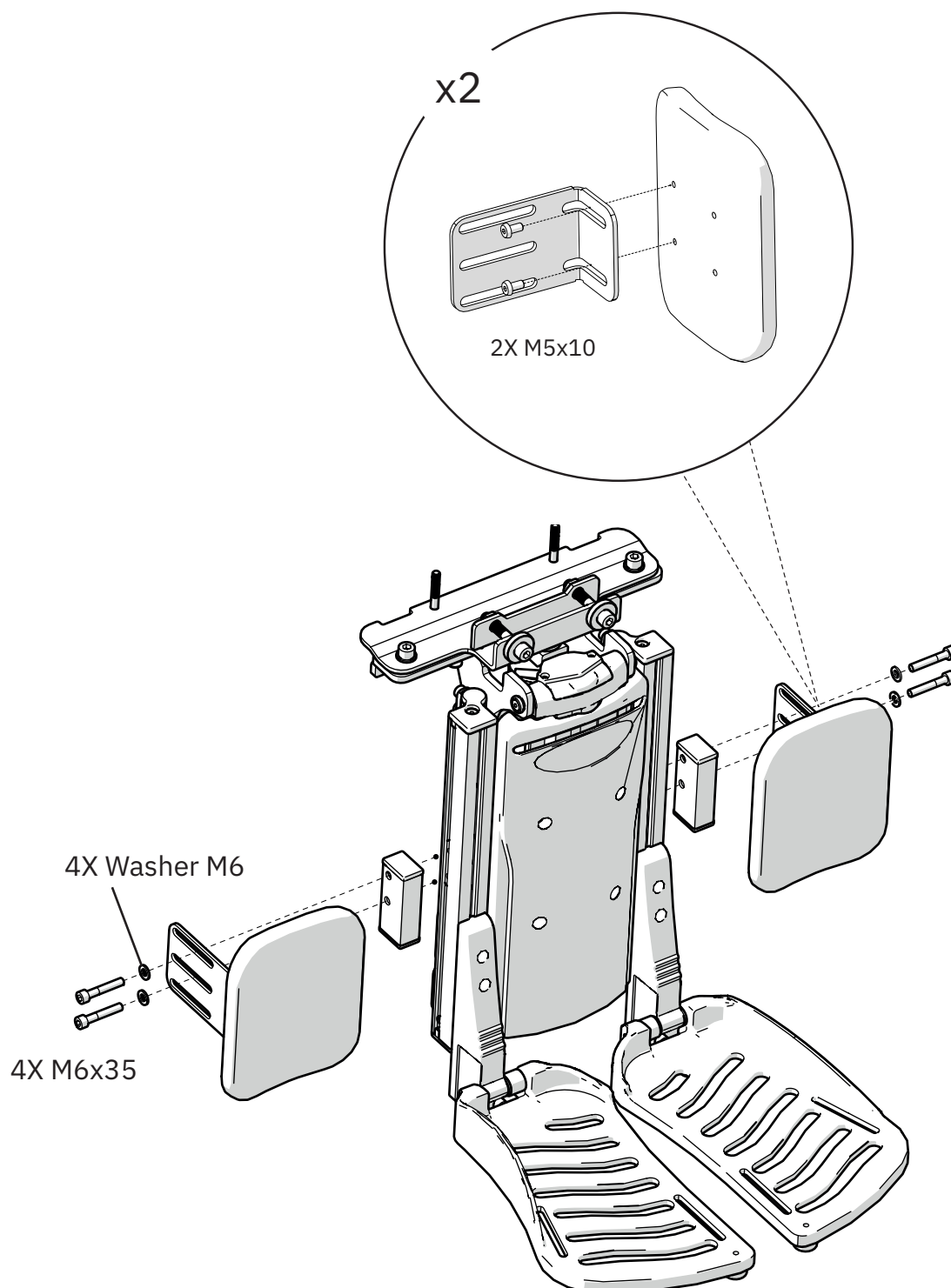

3.3. Install the adapter plate

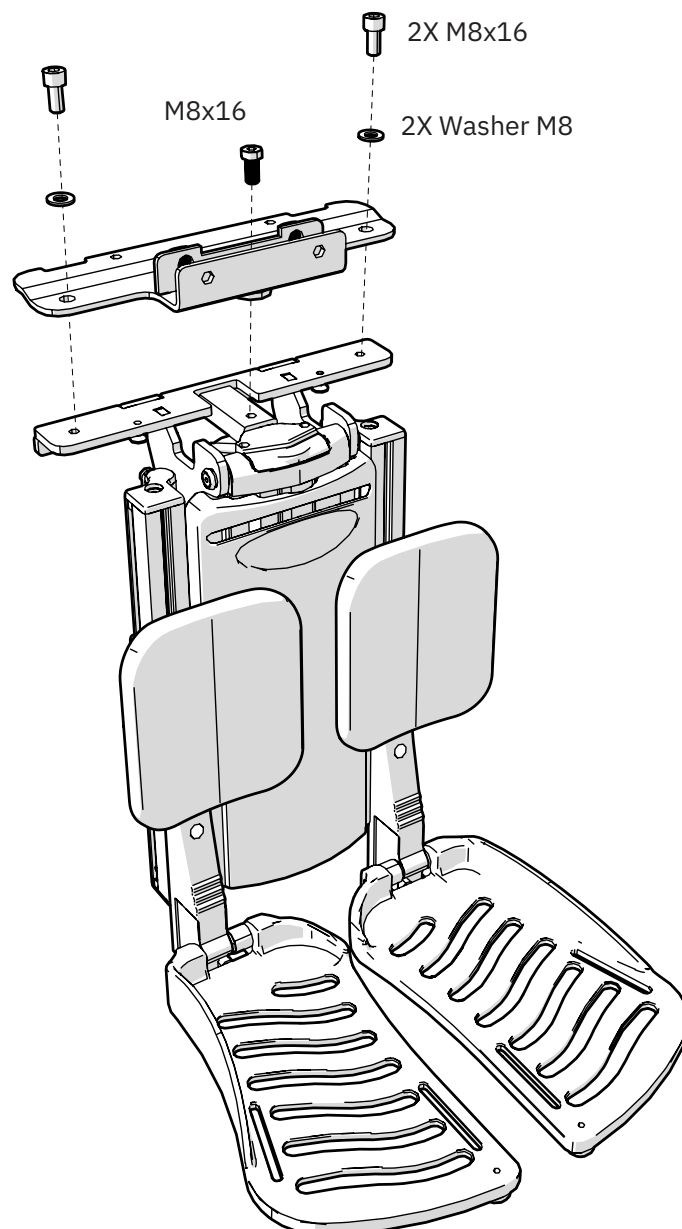

3.4. Install the adapter plate

The chair can be adjusted for 2 different seat depths, 48cm and 53cm.

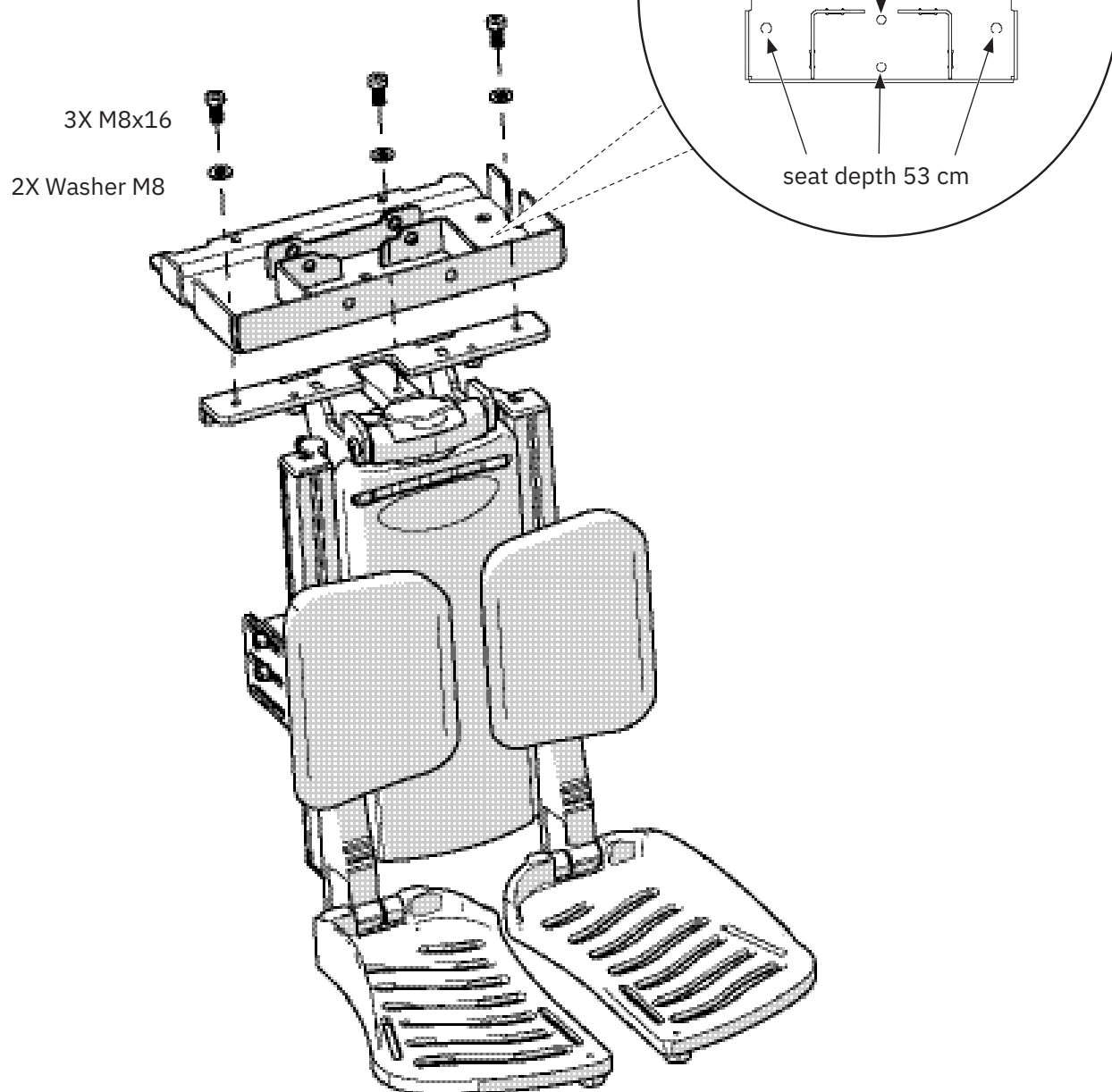

3.5. Install the leg support

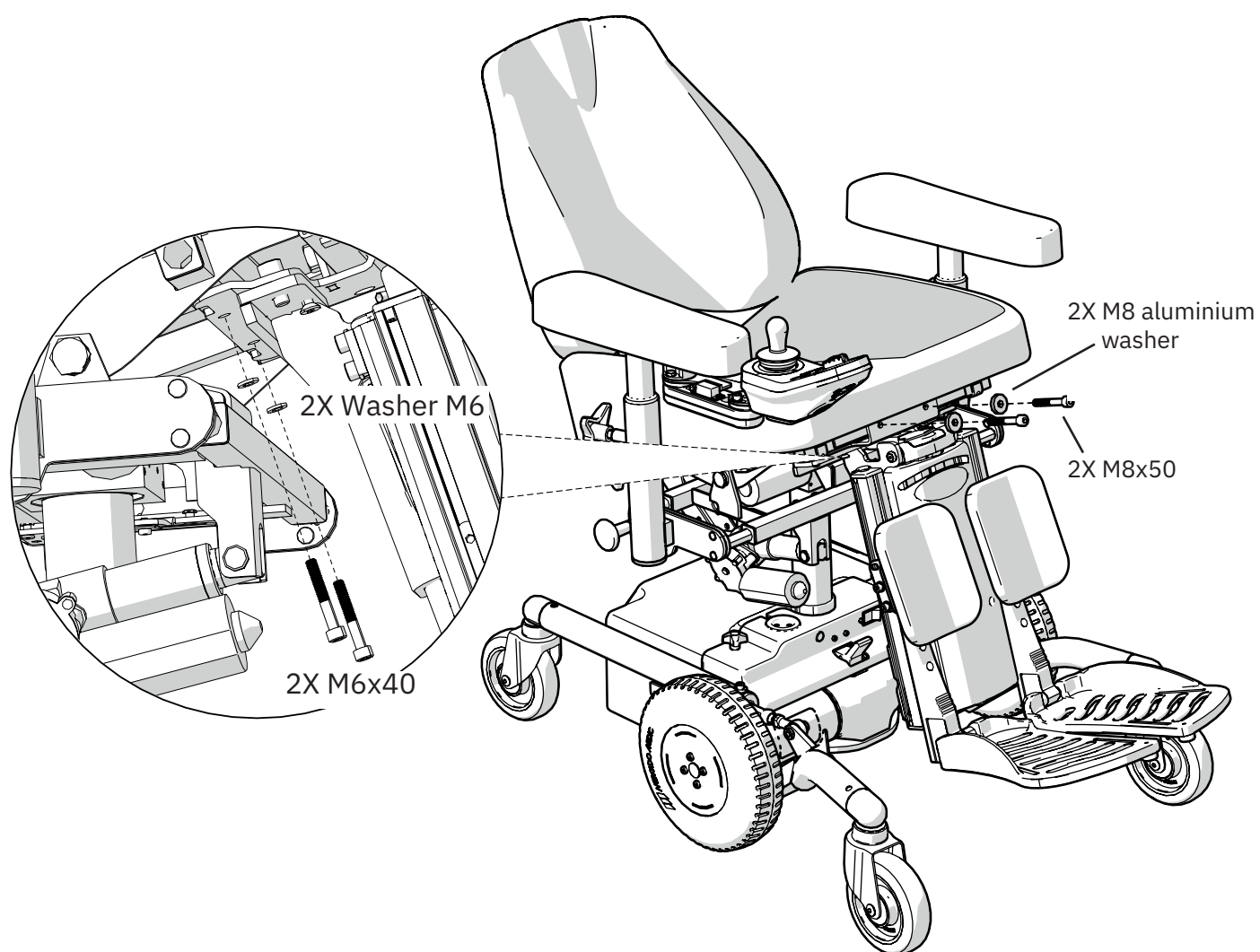

3.6. Install the leg support seat depth 48 and larger

1. Unscrew the seat, 4 pcs M6x40.
2. Mount the leg support with the adapter on the seat cross with the M8x50 screws.
These are inside the adapter.
3. Reassemble the seat plate with the M6x40 screws (4 pcs).
The front two should now secure the leg support.

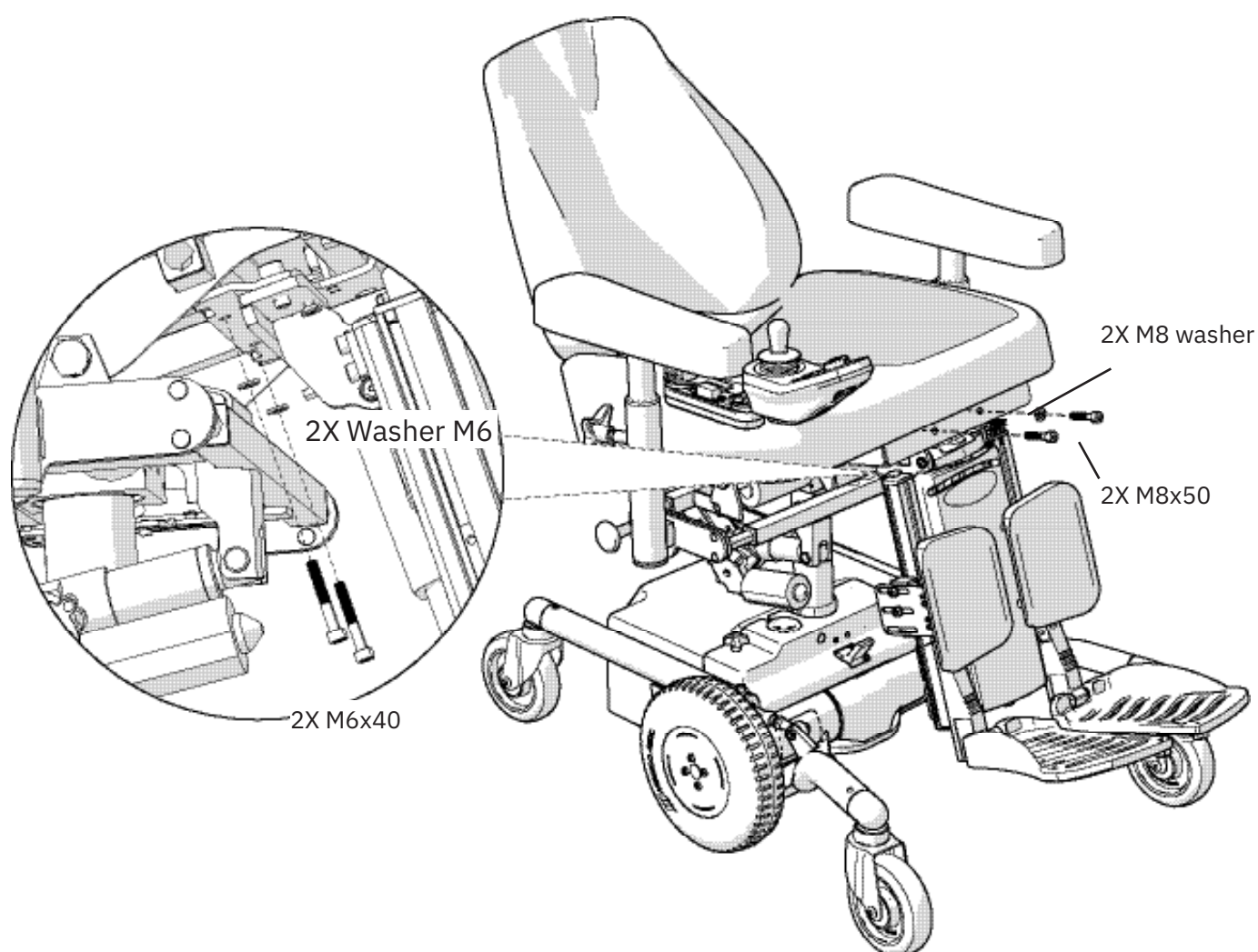

3.7. Connect the electronics

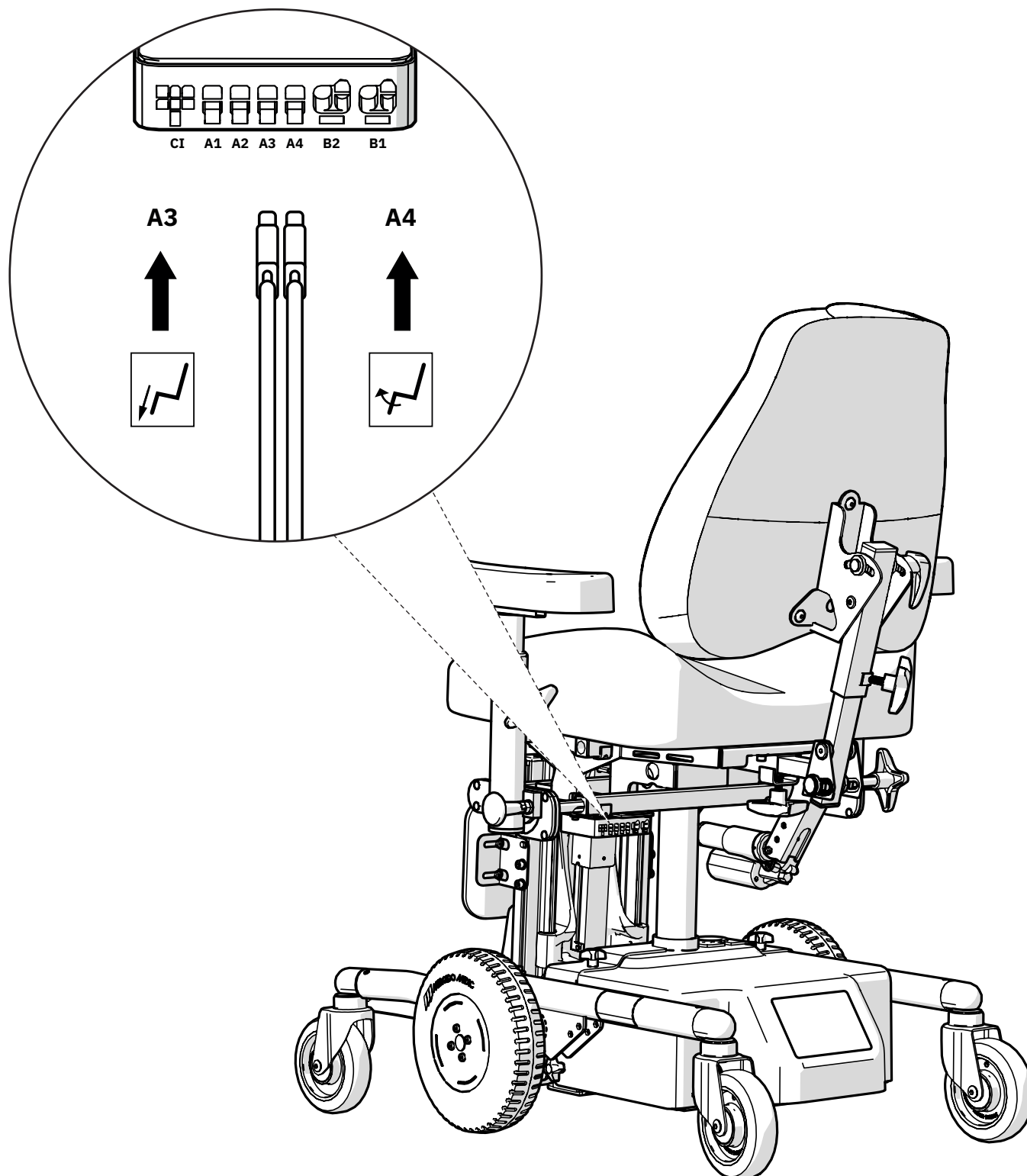

4. Care instructions

The product should be wiped down and kept clean from dust and dirt. We approve the use of detergents with a pH ranging from 7 to a maximum of 12 (concentrated).

5. Disposal and recycling

1. Sort as metal
2. Sort as electronics
3. Sort as combustible

