



PINCH PROTECTION FOR REAL 9000 PLUS BASE

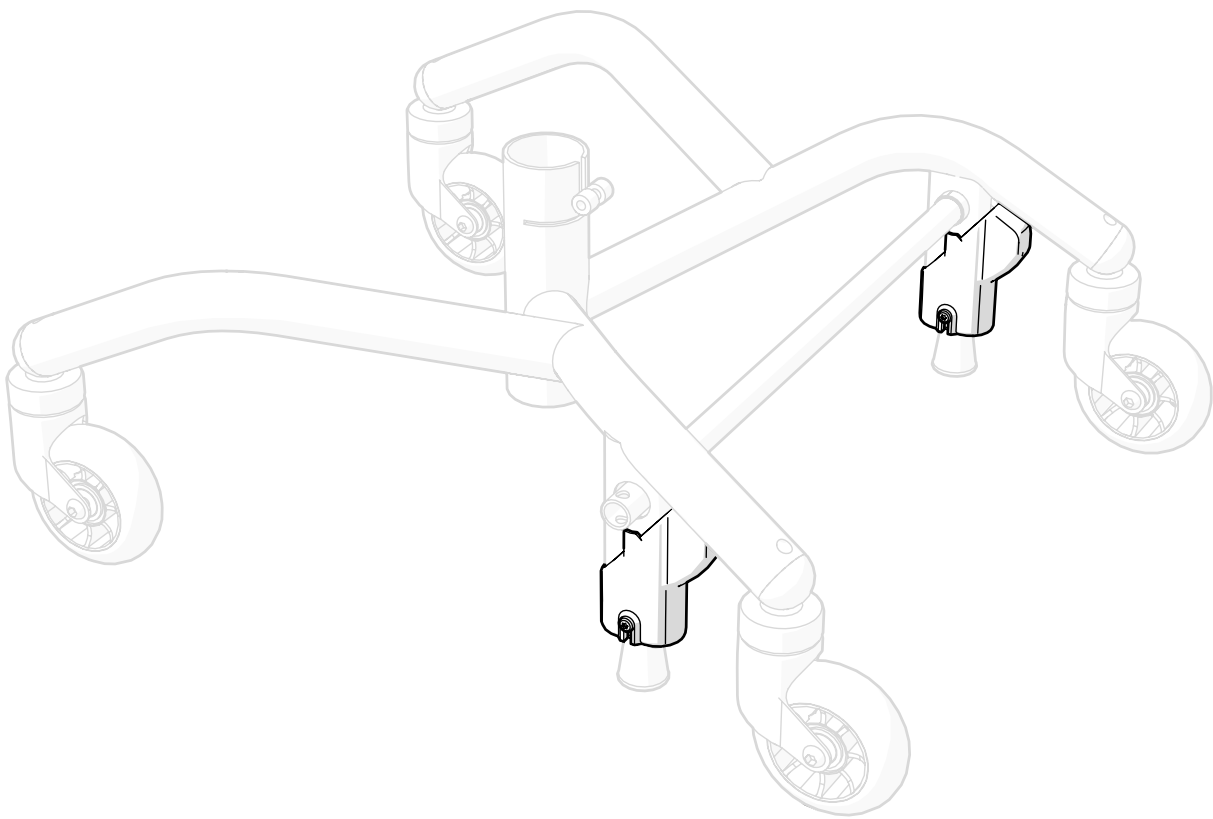
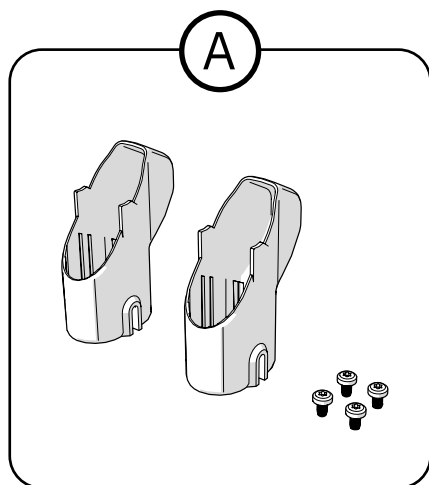

Table of content

- 1. Item list 3
- 2. Warnings 3
- 3. Assembly instructions 4
 - 3.1. Preparations for retrofitting..... 4
 - 3.2. Apply the base’s brake..... 5
 - 3.3. Install the pinch protection..... 6
 - 3.4. Release the brake..... 6
 - 3.5. Tighten the screws 7
 - 3.6. Check 7
- 4. Care instructions 8
- 5. Destruction and recycling 8

1. Item list



- Ⓐ 805192 Pinch protection R+L kit f brake cam f PLUS base black
805193 Pinch protection R+L kit f brake cam f PLUS base white

2. Warnings



Warning!

Risk of crushing between brake cam and base during assembly of the pinch protection.

3. Assembly instructions

The pinch protection should be retrofitted when it is missing on an existing base. It is especially important to have the pinch protection installed a base with backward brake. Most of the instructions shown will be for a base with backward brake, but the instructions also apply for bases with forward brake.

3.1. Preparations for retrofitting

Remove existing screws. These are not needed and can therefore be destroyed or recycled.

Base with backward brake

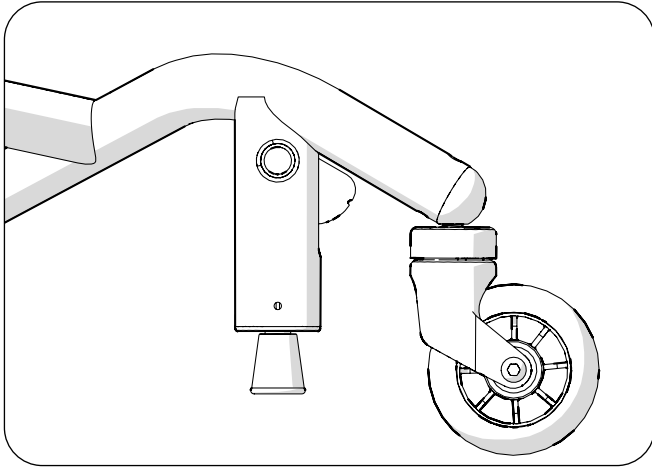

Base with forward brake

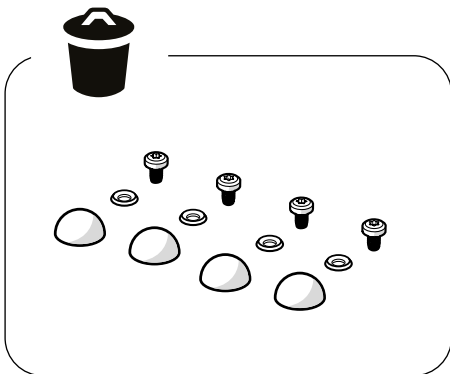
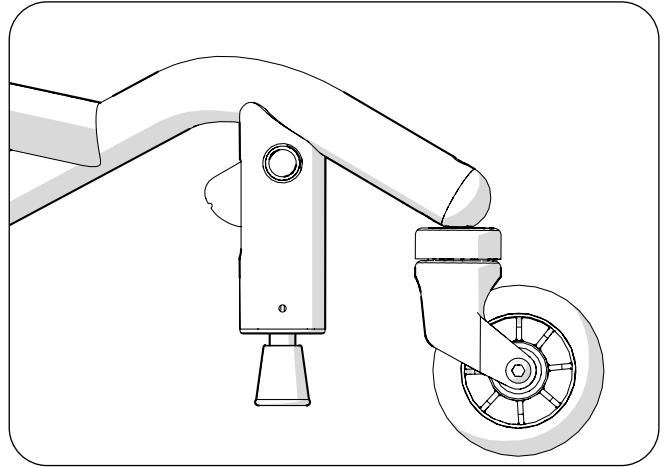

3.2. Apply the base's brake

Ensure that the plastic bushing does not fall out; see the information panel below.



Note the risk of crushing between brake cam and base.

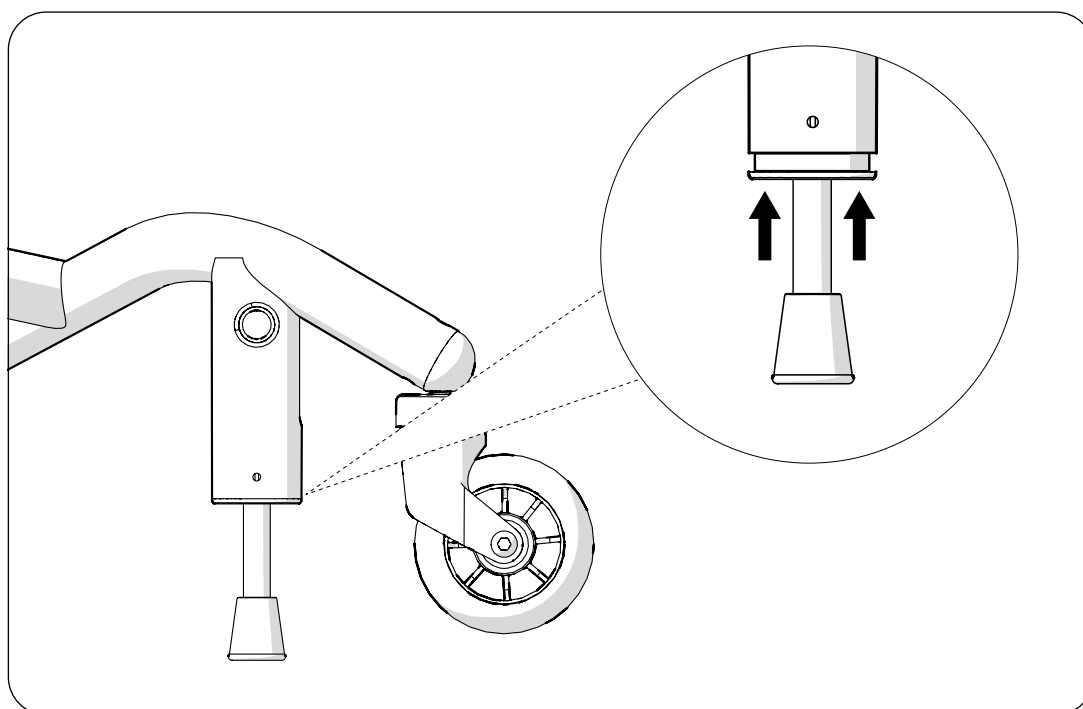
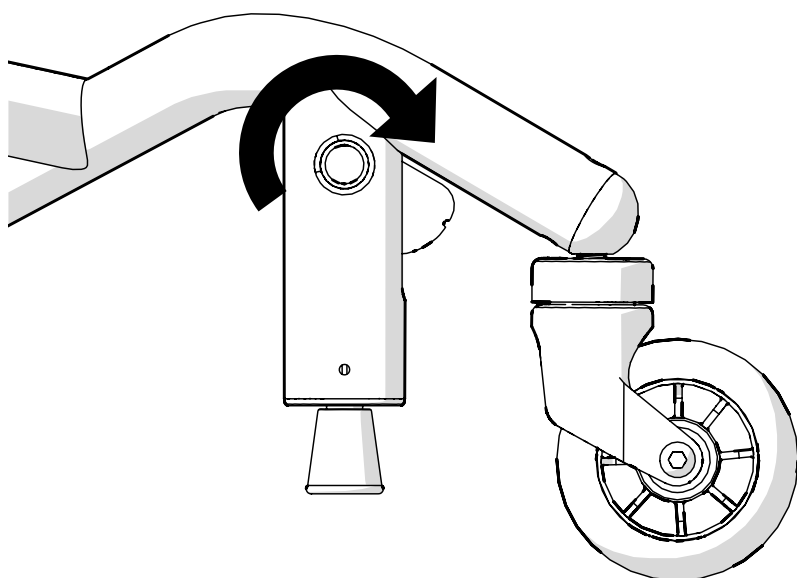

3.3. Install the pinch protection

Ensure that the pinch protection covers the opening for the brake cam in the base. The orientation for installing the pinch protection differs depending on whether the base has forward brake or backward brake.

Push the pinch protection on fully until it stops.



Note the risk of crushing between brake cam and base.

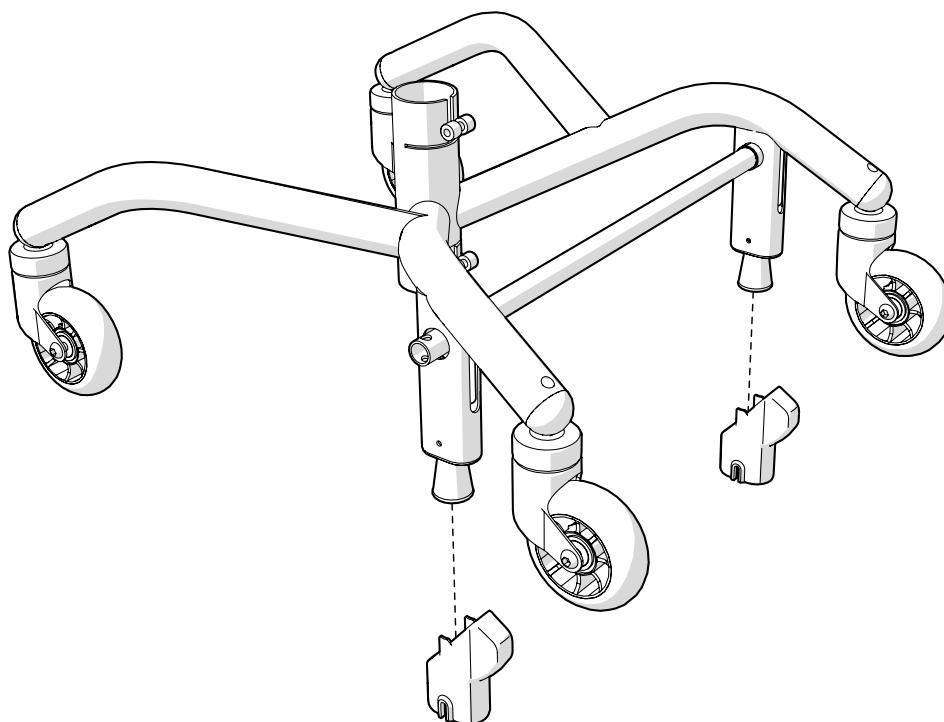

3.4. Release the brake

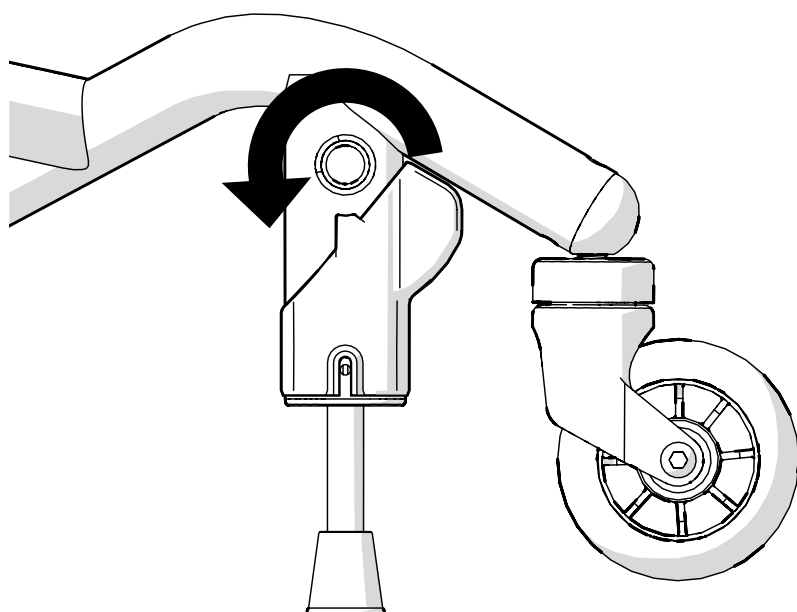

3.5. Tighten the screws

Ensure that the plastic bushing is in position before tightening the screws; see step 3.3.

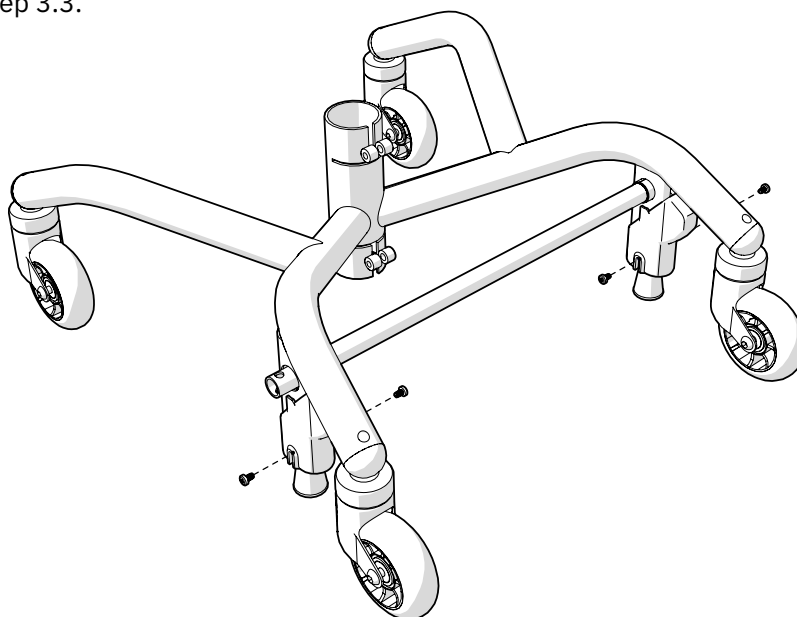

3.6. Check

Now verify that the pinch protection is securely fastened and that the brake cam is covered by the pinch protection. Test the brake to ensure it is working and check that the brake legs move freely.

**Base with backward
brake**

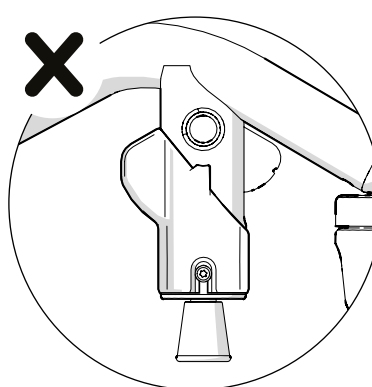
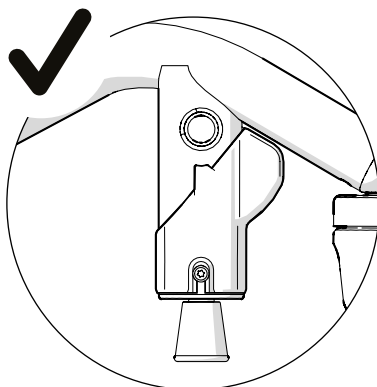

**Base with forward
brake**

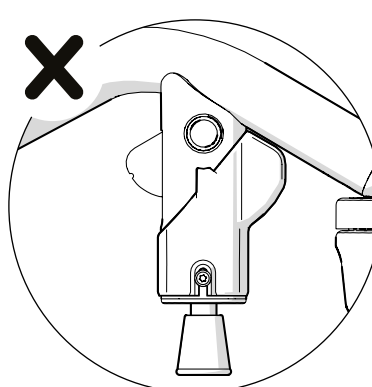
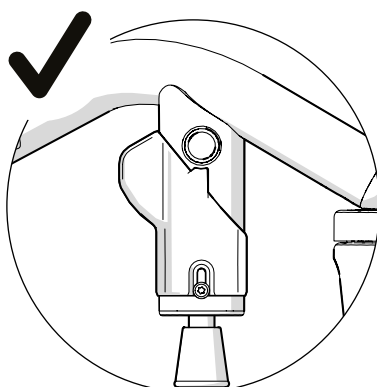

4. Care instructions

No specific care instructions for this item. Follow the instructions in the manual.

5. Destruction and recycling

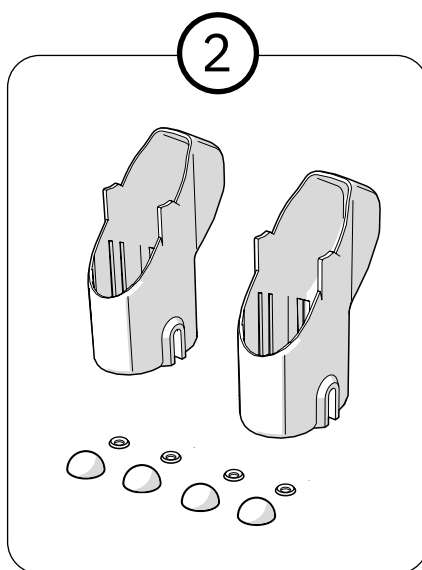
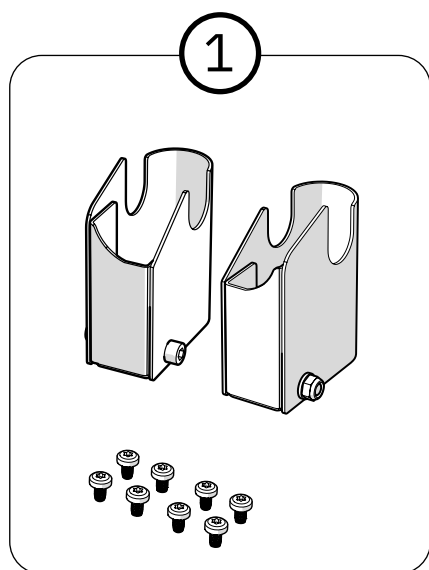

1. Sort as metal
2. Sort as plastic

Contact details

Mercado Medic AB



Mercado Medic AB
Tryffelslingan 14
SE-181 57 Lidingö



+46 (0)8-555 143 00
Mon-Fri 08.00-16.30 (CET/CEST)



www.mercado.se
info@mercado.se