



# REAL<sup>®</sup> 9200 TWIN



## INSTRUCTIONS FOR USE AND CARE REAL 9200 TWIN

Doc. no: 20-06583-UK-02  
Art. no: 805097  
Amended 2020-12-04  
Valid from 2007-06-01

REAL 9200 TWIN is a Class I medical device. It is CE marked in accordance with the Swedish Medical Products Agency's code of statutes for medical devices, LVFS 2003:11, and has been tested and approved in accordance with EN 1335-2, EN 1335-3 and IEC 60601-1-2. All textiles used in the chair have been tested and approved in accordance with EN 1021-1 and EN 1021-2.

Mercado Medic AB is certified to ISO 9001, ISO 14001 and ISO 13485 and complies with applicable labour and environmental legislation.

If you have any questions about your product or if something unexpected has happened, please contact your dealer first, otherwise you are welcome to contact us at Mercado Medic AB.

PDF versions of our instructions for use and care with magnification options can be found on our website: [www.mercado.se](http://www.mercado.se). Information is also provided on the website about accessories that can be installed on Mercado Medic's chairs, as well as any field safety notices, prescribing support or recalls of products and accessories.

We reserve the right to make changes to this manual and its contents.

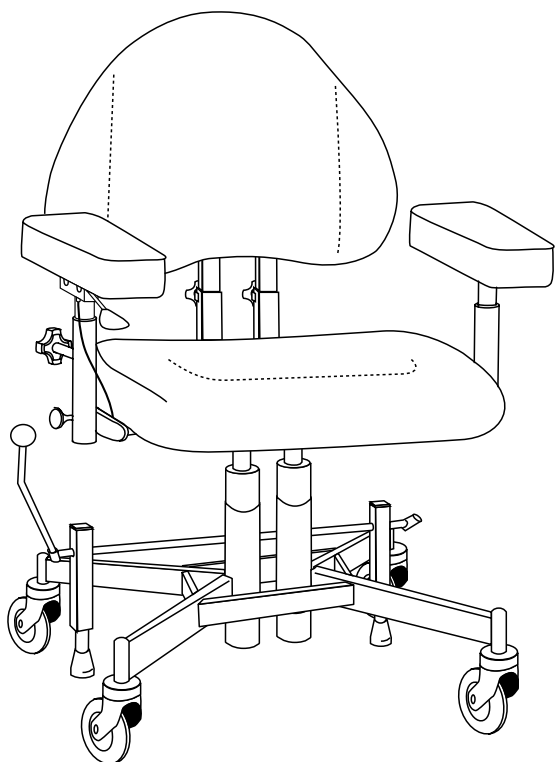

☐ REAL 9200 TWIN

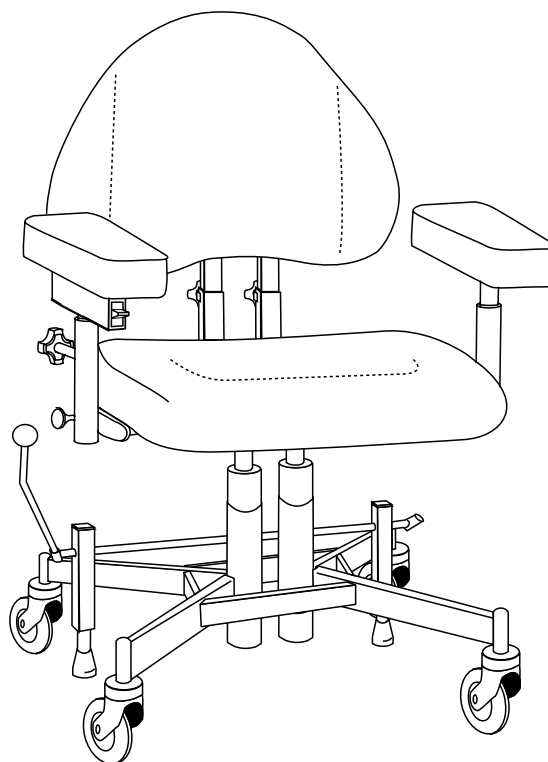

☐ REAL 9200 TWIN EL

**Sufficient competence in the safe use of this product is achieved by carefully reading through these instructions for use and care before using the chair for the first time.**



**Mercado Medic AB**  
Tryffelslingan 14  
SE-181 57 Lidingö

**Telephone & Fax**  
Tel +46 (0)8-555 143 00  
Fax +46 (0)8-555 143 99

**E-mail & Internet**  
E-mail [service@mercado.se](mailto:service@mercado.se)  
Internet [www.mercado.se](http://www.mercado.se)



## CONTENTS

IMPORTANT INFORMATION & CLASS .....	PAGE 3
EXPECTED SERVICE LIFE.....	PAGE 3
CLEANING, CARE AND CHARGING.....	PAGE 4
USER MANUAL .....	PAGE 5
RECONDITIONING AND SERVICE .....	PAGE 6

## IMPORTANT INFORMATION & CLASS

*The REAL chair has replaceable components, accessories and functions with setting options for individual customisation. The chair must only be used by the person for whom it was prescribed and for the purpose for which it is intended. The chair is intended for indoor use and must not be exposed to water, other fluids or chemicals. Nor should it be exposed to high temperatures, prolonged and intense sunlight or other forms of radiation. The chair must not be equipped with any accessories or components other than those approved by Mercado Medic AB. To maintain the CE marking, modifications or changes must not be carried out without Mercado Medic AB's approval. Repairs and other technical measures may only be carried out by personnel authorised by Mercado Medic AB. Read this manual carefully before using the chair for the first time.*

**NOTE!** *The electrical functions may be used for max. 10 % of the time (max. 6 mins/hour). Exceeding this limit may result in damage to the chair.*

## EXPECTED SERVICE LIFE

The expected service life of the Product is ten years when used in accordance with the instructions in this manual. The Product's date of manufacture can be found together with the serial number on one of the silver labels on the Product's chassis, marked with Lev/Del and stated in the format YYWW (number of year and week).

As a user of the Product, you should contact your prescriber, technical aids centre or distributor if the Product shows reduced or altered performance.

After the expected service life, it is important to make an overall assessment of the Product before continuing to use it. After the expected service life, Mercado Medic AB cannot guarantee the suitability and safety of the product, as Mercado Medic AB has no control over how the product has been used and wear and tear. The overall assessment of the Product should be carried out by the healthcare organisation if the product is prescribed, and, as a minimum, should take into account how the Product has been used, the condition of the Product and its component parts, whether the Product has been reconditioned and been serviced, when this occurred, what actions have been taken on these occasions and the reason for the actions.

In markets outside Sweden and Norway where a distributor has sold the Product directly to the user (where applicable), and therefore there is no responsible prescriber, periodic maintenance must be carried out according to instructions in the section Reconditioning and Service in addition to the overall assessment above.

After the expected service life, Mercado Medic AB cannot guarantee the provision of spare parts. CE marking is not affected by expected service life.

The chair should be wiped down and kept free from dust and dirt.

Upholstery should be washed using a foam wash:

1. Remove loose dirt, crumbs and similar.
2. Apply a thin layer of foam and rub the foam in evenly with a damp cloth.
3. Wipe with a clean and lightly dampened cloth.
4. Vacuum clean when dry.

For functional reasons, seats, backrests and other padded parts are not made from impermeable materials. Padded parts should be replaced during reconditioning for hygienic reasons.

The electric lifting mechanisms should be checked regularly for dust, dirt and stability; raise the seat to its highest position. Clean with a cloth. Do not use any water or solvents. Then lubricate the cylinder using a thin layer of Teflon or silicone-based grease.

The chair may only be charged using battery charger REAL 9000 type 2240-12V, with article no. 802289. The battery should be charged regularly; once a day if possible. It is important that the battery is never completely discharged, as this helps to prolong the life of the battery. Connect the charging plug (1) on the charger to the socket on the box with the rocker switch for raising and lowering the chair. Then plug the charger's plug (2) into a wall socket. The LED on the charger will indicate that charging is under way. When the LED changes colour from yellow to green, the battery is fully charged. The chair can be raised and lowered while charging is in progress. This applies to EL chairs delivered from week 11, 2013 or previously delivered updated chairs.

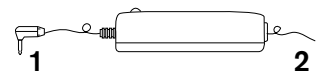

**NOTE!** It is particularly important to charge the battery on chairs with electric brakes, electric tilt mechanisms and electric backrest mechanisms because these functions require a high battery capacity to be maintained. To avoid loss of function, charge the battery once a day. When changing the battery (type designation: FGV 20721 12V 7.2Ah), be sure to attach the battery cable marked as positive to the positive terminal on the battery and the negative cable to the negative terminal. If the chair's electrical functions stop working, this is likely due to a blown fuse. Check the fuses in the fuse holders located under the seat on the cable between the battery and the actuator. Replace the blown fuse with a new 25A fuse.

Bear in mind the following when handling batteries:

Never short-circuit the battery. • Do not throw the battery into fire. • Do not expose the battery to excessive shocks. • In case of contact with battery acid, rinse with water for about 15 minutes. Seek medical advice. • Batteries must be disposed of at appropriate recycling facilities.

## BACKREST

Twin uses one type of backrest mechanism: Medic. The backrest mechanism has separate controls for setting the height (1) and angle (2). Loosen the knobs on both backrest mechanisms, set the desired height/angle, and then lock the knobs. The depth of the Medic backrest mechanism can be adjusted using the knob (3). The angle of the backrest itself is adjusted using the lever (4).

**NOTE!** Make sure that the Medic backrest mechanism is adjusted in the bracket so the spring button clip locks and the backrest mechanism cannot be pulled out.

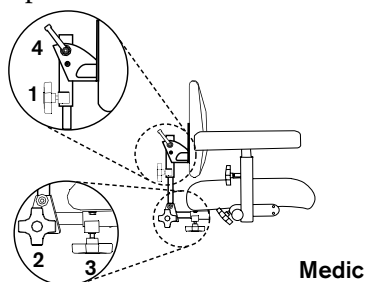

## ARMRESTS

The armrests are height and width adjustable and can be folded back. The height is adjusted using the wheel (1). To lower the armrest: screw the wheel outwards. To raise the armrest: lift the armrest to the desired height and then lock the wheel. The width is adjusted using the wheel (2). Loosen the wheel, adjust and lock. To fold the armrests up or down, use the knob (3). Pull out and fold back. The device locks automatically when the armrest is folded back to the upright position. Automatic locking can be prevented by turning the knob (3) a quarter turn.

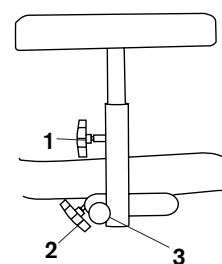

## SEAT HEIGHT

### TWIN EL

The seat height is adjusted using the rocker switch (1) under one of the armrests. To raise the seat: press the top part of the switch. To lower the seat: press the lower part of the switch. The seat height can also be adjusted using a separate control unit (2). The left button raises the seat and the right button lowers it.

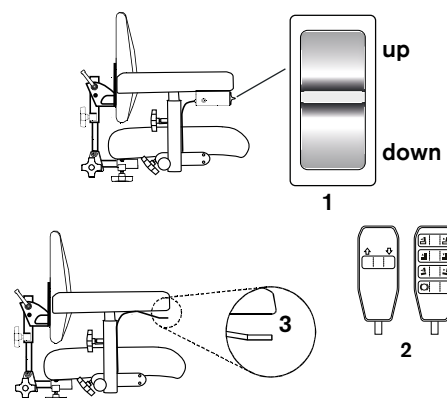

### TWIN MANUAL

The height is controlled by the lever (3) to one side of the armrest (standard right). Lift the lever to change the height setting.

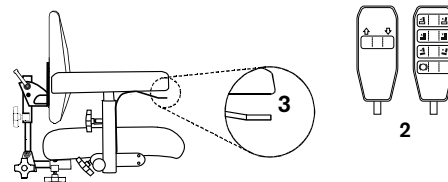

## HANDBRAKE

The brake is controlled by a lever (1). To apply: move the lever forward. The brake lever can be installed on either side of the chair.

**NOTE!** The brake on the chair must always be applied when getting in and out of the chair. The brake must be checked on a regular basis. In case of wear, change the brake rubber. The braking function may be reduced on uneven surfaces.

When operating the electric brake: press and hold the button (2) for at least one second.

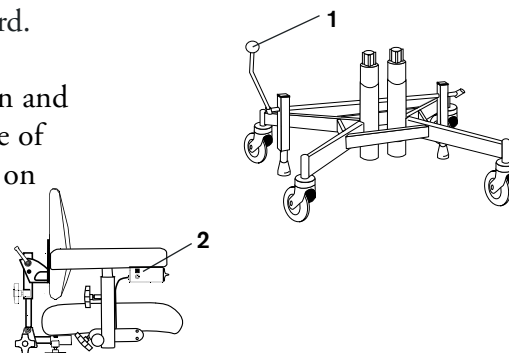

### ! Important information for reconditioning and servicing REAL 9200 chairs (hereinafter referred to as the Product):

- The Product does not require periodic maintenance in cases where it has a responsible prescriber in the healthcare sector. In markets outside Sweden and Norway where a distributor has sold the Product directly to the user (where applicable), and therefore there is no responsible prescriber, periodic maintenance must be carried out every other year throughout the Product's entire life cycle according to sections 1-10 in this section.
- A thorough visual inspection must be performed of the Product's main components in connection with service and reconditioning in order to ensure the user's safety. These include the base, lifting mechanism, seat frame, back recliner and U-bars for armrests. The inspection must include welds, lockable functions and settings.
- The user must not sit in the Product while it is being reconditioned or serviced or during maintenance.
- Do not use high pressure washers when cleaning the Product.
- When checking the base, always inspect the weld between the base's front and rear legs. Any indication of cracks in the material or paint in this area should be regarded as reason to replace the base, or the Product.
- In case of reduced braking action, check both the stability of the base and the condition of the brake rubber. If the Product is not resting on all four wheels in the unbraked position, the Product must be withdrawn from service immediately. Check for instability in different locations and directions to rule out the floor as the cause of any instability.

#### 1. Electronics unit

##### ☐ 1.1. Electronics/function/cleaning

Check the electronics and see which electrical functions are connected. Test electrical functions; if the chair does not work, try connecting the charger for at least 10 seconds. Check for any damage to the electronics box.

##### ☐ 1.2. Control unit / function / cleaning

Check the functions of the controls, and check that the housing is intact and that all buttons are working. Wipe the controls with a cloth lightly dampened with disinfectant; this is to avoid the risk of cross-infection. Do not use solvents, bleach, polishes, synthetic detergents, polishing waxes or sprays on the chair.

##### ☐ 1.3. Connectors / attachment

Check that cables and connectors are intact and properly secured. Make sure that cables and connectors cannot be pinched or crushed.

##### ☐ 1.4. Batteries/battery charger/function

Check that the charger is working and that the housing and cables are undamaged.

Check the batteries' voltage

and that there is not too great a difference between the batteries' charge; this indicates that a battery cell has failed.

##### ☐ 1.5. Electric seat tilt / function

Check that the actuator is not visibly damaged. Check the function of the actuator's moving parts. Ensure that all locking screws are tightened to avoid any play in the end position.

##### ☐ 1.6. Electric backrest / function

Check that the actuator is not visibly damaged. Check the function of the actuator's moving parts. Ensure that all locking screws are tightened to avoid any play in the end position.

##### ☐ 1.7. Electric brake / function

Check that the actuator is not visibly damaged. Check the function of the actuator's moving parts. Ensure that all locking screws are tightened to avoid any play in the end position.

Check all joints and that the clamp mounting on the brake shaft and base tube is correctly positioned.

#### 2. Electric lifting mechanism

##### ☐ 2.1. Noise / sliding clutch

Listen for any abnormal noise in the electric lifting mechanism, and replace the electric lifting mechanism if a bearing is defective in any way. The electric lifting mechanism can be sent to Mercado Medic AB for repair/reconditioning.

Load the chair and check that the electric lifting mechanism does not slip to lowered. Otherwise ensure the correct torque for the sliding clutch.

##### ☐ 2.2. Rotation lock / lubrication

Check that there is no play in the electric lifting mechanism in the direction of rotation. If there is, replace the electric lifting mechanism. The electric lifting mechanism can be sent to Mercado Medic AB for repair/reconditioning.

##### ☐ 2.3. Attachment / tightening

Check that the seat frame and base are correctly assembled and tightened.

##### ☐ 2.4. Cabling / wear

Inspect cables for any signs of wear, pinching or crushing.

#### 3. Chassis

##### ☐ 3.1. Welds

Check all welds carefully for signs of cracks, corrosion, movement, etc.

##### ☐ 3.2. Bolted joints

Check and tighten all bolted joints. Replace screws that have damaged heads or threads.

#### 4. Brakes

##### ☐ 4.1. Function / wear

Replace the brake rubber and check that the brake is working properly.

## RECONDITIONING, CONT.

- ☐ 4.2. Plastic plugs / guide bushings

Make sure that guide bushings and plastic plugs are properly secured, and replace worn or damaged parts.

### 5. Castors

- ☐ 5.1. Function / roll / swivel

Remove hair and dust from the castors and check castors and castor housings for wear and play, which may indicate defective bearings. Check that the castors swivel and the housings rotate as expected. Replace castors if necessary.

- ☐ 5.2. Attachment / tightening

Check that the castors' screws are intact and tightened.

### 6. Seat frame

- ☐ 6.1. Mechanics / welds

Check all welded parts carefully (especially when mounting tilt mechanisms, as these parts carry the most load).

- ☐ 6.2. Bolted joints / tightening

Check and tighten all bolted joints. Replace screws that have damaged heads or threads.

- ☐ 6.3. Plastic plugs / guide bushings

Make sure that guide bushings and plastic plugs are properly secured, and replace worn or damaged parts.

- ☐ 6.4. Seat / replacement / cleaning

Replace the seat with a new one and wash or replace any covers.

- ☐ 6.5. Control / lubrication

Make sure that all knobs and wheels on the seat frame are working and that they lock correctly.

- ☐ 6.6. Gas spring tilt / function

If the chair is equipped with gas tilt controls, check that these lock securely and that there is no gradual change in tilt when loaded. Check and replace damaged wires and sheaths.

- ☐ 6.7. Crank tilt controls / wear

If the chair is equipped with crank tilt controls, check that there is no play and that all screws are tightened.

- ☐ 6.8. Coxit mechanism / control

Make sure that the knobs for the flaps turn easily and are securely locked with the counter nut.

### 7. Backrest mechanism

- ☐ 7.1. Function / wear

Check and replace any worn parts, and make sure that moving parts are working correctly.

- ☐ 7.2. Attachment / tightening

Check that all screws, knobs and wheels lock properly and that the spring button clips are working correctly.

- ☐ 7.3. Plastic plugs / guide bushings

Make sure that guide bushings and plastic plugs are properly secured, and replace worn or damaged parts.

- ☐ 7.4. Backrest / replacement / cleaning

Replace the backrest with a new one and wash or replace any covers.

- ☐ 7.5. Gas spring lever / function

Check the gas pressure and stability of the gas spring. Ensure that it locks securely and that there is no gradual change in the backrest angle when loaded. Check and replace damaged wires and sheaths.

### 8. Armrests

- ☐ 8.1. Function / wear

Check and replace any worn parts and make sure that locking mechanisms and moving parts are working correctly.

- ☐ 8.2. Plastic plugs / guide bushings

Make sure that guide bushings and plastic plugs are properly secured, and replace worn or damaged parts.

- ☐ 8.3. Armrest plates / replacement / cleaning

Replace armrest plates with new ones.

- ☐ 8.4. Armrest mechanics / function

Check all welds and that there is no damage to the tube system that may impair or weaken the structure.

### 9. Accessories

- ☐ 9.1. Restoration

Remove any accessories that are not normally installed on the chair and inspect them as detailed below before potentially placing them in storage.

- ☐ 9.2. Mechanics

Check all welds and that there is no damage to mechanical parts that may impair or weaken the structure.

- ☐ 9.3. Function / wear

Check and replace any worn parts and make sure that locking mechanisms and moving parts are working correctly.

- ☐ 9.4. Padded parts

Discard padded parts to prevent cross-infection, and discard or wash covers according to washing instructions.

### 10. Final inspection

- ☐ 10.1. Testing

Test the chair's functionality and that all individual functions, electrical functions and brakes are working correctly. If the chair is to be stored for a period, the chair must be put in sleep mode using the appropriate 9V adapter to save the batteries.

# CONTACT MERCADO

## Head office

Visiting address

Tryffelslingan 14, SE-181 57 Lidingö

Postal address

Box 1074, SE-181 22 Lidingö

Switchboard is open: Mon-Fri 08.00-16.30 (CET/CEST)

Tel: +46 (0)8-555 143 00

Fax: +46 (0)8-555 143 99

E-mail: [info@mercado.se](mailto:info@mercado.se)

## Service and technical support

Telephone hours Mon-Fri

08.00-12.00 and 13.00-16.00 (CET/CEST)

Tel: +46 (0)8-555 143 08

Fax: +46 (0)8-555 143 99

Mobile phone: +46 (0)70-550 63 98

+46 (0)70-894 63 68

E-mail: [service@mercado.se](mailto:service@mercado.se)

*[Space for product label with serial number.]*